

BOROUGH OF BROXBOURNE
ROAD TRAFFIC REGULATION ACT 1984

THE BOROUGH OF BROXBOURNE (VARIOUS ROADS)
(DISABLED PERSONS' PARKING PLACES) ORDER 2015

THE COUNCIL OF THE BOROUGH OF BROXBOURNE, pursuant to arrangements made with the Hertfordshire County Council under Section 19 of the Local Government Act 2000 and the Local Authorities (Arrangements for the Discharge of Functions) (England) Regulations 2000, and in exercise of its powers under Sections 32 and 35 of the Road Traffic Regulation Act 1984, (hereinafter called "the 1984 Act") and of all other enabling powers, and after consultation with the Chief Officer of Police in accordance with Part III of Schedule 9 of the Act of 1984, hereby make the following Order:

1(1) In this Order

"Disabled Person's Badge" has the same meaning as in The Local Authorities' Traffic Orders (Exemptions for Disabled Persons) (England) Regulations 2000.

"Disabled Person's Vehicle" has the same meaning as in Section 142(1) of the 1984 Act

"Driver", in relation to a vehicle waiting in a Parking Place, means the person driving the vehicle at the time it was left in the Parking Place

"Parking Place" means any part of a road authorised by this Order to be used as a parking place

(2) For the purposes of this Order a vehicle shall be regarded as displaying a Disabled Person's Badge in the relevant position if:

- (i) in the case of a vehicle fitted with a dashboard or fascia panel, the badge is exhibited thereon so that the serial number and the date of expiry of the badge is legible from outside the vehicle; or
- (ii) in the case of a vehicle not fitted with a dashboard or fascia panel, the badge is exhibited in a conspicuous position on the vehicle so that the serial number and the date of expiry of the badge is legible from outside the vehicle.

2(1) Those parts of the roads specified in Column 1 of Schedule 1 and shown for identification purposes only in the plan in the Schedule to this Order are authorised to be used in a position specified in Column 2 of the said Schedule 1 and subject to the following provisions of this Order, as Parking Places at any time for Disabled Person's Vehicles which display in the relevant position a Disabled Person's Badge.

(2) Nothing in paragraph (1) of this Article shall restrict the power of the Council, for preventing obstruction of the roads, by order, or by notice on the occasion of any public procession, rejoicing or illumination, or when the roads are thronged or liable to be obstructed, to close the Parking Place.

3 Where in Column 1 of Schedule 1 to this Order a Parking Place is described as available for a Disabled Person's Vehicle which displays in the relevant position a Disabled Person's Badge, the Driver of a vehicle shall not permit it to wait in that Parking Place unless it is:

- (a) a Disabled Person's Vehicle on which is displayed in the relevant position a Disabled Person's Badge, and
- (b) wholly within the limits of the Parking Place.

- 4 A Driver of a vehicle shall not use a Parking Place:-
 - (a) so as unreasonably to prevent access to any premises adjoining the road, or the use of the road by other persons, or so as to be a nuisance;
 - (b) when for preventing obstruction of the road the Council shall by order or by notice made on the occasion of any public procession, rejoicing or illumination or when the roads are thronged or liable to be obstructed have closed that Parking Place and exhibited notice of such closing on or near the Parking Place.
- 5 The Driver of a motor vehicle using a Parking Place shall stop the engine as soon as the vehicle is in a position in the Parking Place, and shall not start the engine except when about to change the position of the vehicle in or to depart from the Parking Place.
- 6 No person shall use a vehicle, while it is in a Parking Place, in connection with the sale of any article to persons in or near the Parking Place or in connection with the selling or offering for hire of his skill or service.
- 7 Subject to the provision hereto, when a vehicle is left in a Parking Place in contravention of any of the provisions contained in Articles 3 and 4 of this Order a person authorised in that behalf by the Council may remove the vehicle or arrange for it to be removed from that Parking Place provided that when a vehicle is waiting in a Parking Place in contravention of the provisions of Articles 3 and 4 of this Order, a person authorised in that behalf by the Council may alter or cause to be altered the position of the vehicle in order that its position shall comply with that provision.
- 8 Any person removing a vehicle or altering its position by virtue of Article 7 of this Order may do so by towing or driving the vehicle or moving the vehicle in such other manner as he may think necessary and may take such measures in relation to the vehicle as he may think necessary to enable him to remove it or alter its position, as the case may be.
- 9 When a person authorised by the Council removes or makes arrangements for the removal of a vehicle from a Parking Place by virtue of Article 7 of this Order, he shall make such arrangements as may be reasonably necessary for safe custody of the vehicle.
- 10 The lengths of road specified in Schedule 2 of this Order are no longer authorised for the sole parking of disabled persons vehicles.
- 11 The provisions of The Borough of Broxbourne (Control of Parking) (Consolidation) Order 2013 ("the 2013 Order") are hereby revoked but only in so far as they are affected by the restrictions imposed by this Order.
- 12 Paragraph 2 of Schedule 1 of the Borough of Broxbourne (Various Roads) (Disabled Persons Parking Places) Order No.2 2013 is revoked.
- 13 Paragraph 7 of Schedule 1 of the Borough of Broxbourne (Various Roads) (Disabled Persons Parking Places) Order No.2014 is revoked.
- 14 This Order shall come into operation on 5th May 2015 and may be cited as the Borough of Broxbourne (Various Roads) (Disabled Persons' Parking Places) Order 2015.

SCHEDULE 1

Column 1	Column 2
Description of the Parking Place	Position in which the vehicle may wait
ST AUGUSTINES CLOSE, BROXBOURNE east side from a point in line with the boundary between Nos. 30 & 32 High Road, Broxbourne northward for a distance of 6.0m.	Parallel and adjacent to the kerb
DEWHURST ROAD, CHESHUNT south side from a point in line with the boundary between Nos. 50 & 52 westward for a distance of 6.0m.	Parallel and adjacent to the kerb
DEWHURST ROAD, CHESHUNT west side from a point 11m north of a point in line with the northern front wall of No.99a northward for a distance of 2.4m.	Lengthwise at 90° to the kerb in a East/ West direction
DOWNFIELD ROAD, CHESHUNT east side from a point 10.5m south of a point in line with the southern front wall of No.1 Wood Green Way southward for a distance of 6.0m	Parallel and adjacent to the kerb
ELGIN ROAD, CHESHUNT west side from a point 1m south of a point in line with the southern flank wall of No.5 northward for a distance of 6.0m.	Parallel and adjacent to the kerb
FRANKLIN AVENUE, CHESHUNT west side from a point in line with the boundary between Nos.4 & 6 southward for a distance of 3.0m.	Lengthwise at 90° to the kerb in a East / West direction
PEAKES LANE, CHESHUNT east side from a point in line with the boundary between Nos. 4 & 6 southward for a distance of 6.0m.	Parallel and adjacent to the kerb
THE MEAD, CHESHUNT south side from a point 3.5m west of a point in line with the western front all of No.9 westwards for a distance of 2.4m	Lengthwise at 90° to the kerb in a North / South direction
BURFORD STREET, HODDESDON west side from a point 2m south of a point in line with the boundary between Nos.104 & 106 southward for a distance of 6.0m.	Parallel and adjacent to the kerb
CEDAR GREEN, HODDESDON east side from a point in line with the boundary between Nos. 13 & 14 southward for a distance of 6.0m.	Parallel and adjacent to the kerb
DANEMEAD, HODDESDON east side from a point 0.7m north of a point in line with the southern flank wall of No. 12 northwards for a distance of 2.4m.	Lengthwise at 90° to the kerb in a East / West direction

LORD STREET, HODDESDON north side from a point in line with the boundary between Nos. 176 & 178 westward for a distance of 6.0m.	Parallel and adjacent to the kerb
NEW RIVER CLOSE, HODDESDON east side from a point 1.5m north of a point in line with the southern flank wall of No.5a northward for a distance of 6.0m.	Parallel and adjacent to the kerb
NEW RIVER CLOSE, HODDESDON north side from a point in line with the southern front wall of No.5a southward for a distance of 2.4m.	Lengthwise at 90° to the kerb in a East / West direction
NEW RIVER CLOSE, HODDESDON south side from a point 3.1m west of a point in line with the western flank wall of No .8c westward for a distance of 2.4m.	Lengthwise at 90° to the kerb in a South / North direction
OLD HIGHWAY, HODDESDON east side from a point in line with the boundary between Nos.110 & 112 southward for a distance of 6.0m.	Parallel and adjacent to the kerb
RYE ROAD, HODDESDON north side from a point in line with the eastern flank wall of No. 68 westward for a distance of 6.0m	Parallel and adjacent to the kerb
RAGLAN AVENUE, WALTHAM CROSS west side from a point 1.6m south of a point in line with the northern flank wall of No.35 northwards for a distance of 6.0m.	Parallel and adjacent to the kerb
HIGH ROAD, WORMLEY east side from a point in line with the boundary between Nos. 3a & 5 northward for a distance of 6.0m.	Parallel and adjacent to the kerb
MACERS LANE, WORMLEY south side from a point 9.5m in line with the eastern flank wall of No. 188 eastward for a distance of 3.0m.	Lengthwise at 90° to the kerb in a South / North direction

SCHEDULE 2

Description of those parking places to be removed

Brookfield Gardens, Cheshunt west side from a point 0.5m north of a point in line with the boundary between Nos. 1 & 3 Brookfield Gardens northward for a distance of 6 metres.

Burleigh Road, Cheshunt west side from a point 0.5m north of a point in line with the boundary between Nos.6 & 7 Burleigh Road southwards for a distance of 6m.

Bury Green Road, Cheshunt south side from a point 3.4m west of a point in line with the boundary between Nos.65 & 67 Bury Green Road westward for a distance of 2.4 metres.

Church Lane, Cheshunt north side from a point 1.5m west of a point in line with the western flank wall of No. 147 Church Lane eastward for a distance of 6 metres

College Road, Cheshunt north side from a point 1.1m west of a point in line with the boundary between Nos. 48 & 50 College Road westwards for a distance of 5 metres.

Elderbek Close, Cheshunt west side from a point 1.7m south of a point in line with the boundary between Nos.63 & 64 Elderbek Close southwards for a distance of 6 metres.

Lawrance Gardens, Cheshunt west side from a point in line with the boundary between Nos.39 & 40 Lawrance Gardens northward for a distance of 5 metres

Prospect Road, Cheshunt west side from a point 1.5m north of a point in line with the boundary between No.77 & 79 Prospect Road southwards for a distance of 5.5 metres.

Tudor Close, Cheshunt south side from a point in line with a point 18.5m east of the eastern flank wall of No.18 Tudor Close eastwards for a distance of 3.5 metres.

Whitefields Road, Cheshunt west side from a point 0.85m south of the southern flank wall of Nos.187 – 193 Whitefields Road northwest-wards for a distance of 6.2 metres.

Old Essex Road, Hoddesdon north side from a point in line with the boundary between Nos.40 & 42 Old Essex Road westward for a distance of 6 metres

Old Highway. Hoddesdon west side from a point in line with the boundary between Nos.63 & 63 Old Highway southward for a distance of 6 metres.

Felstead Road, Waltham Cross north side from a point in line with the boundary between Nos.18 & 20 Felstead Road eastward for a distance of 6 metres.

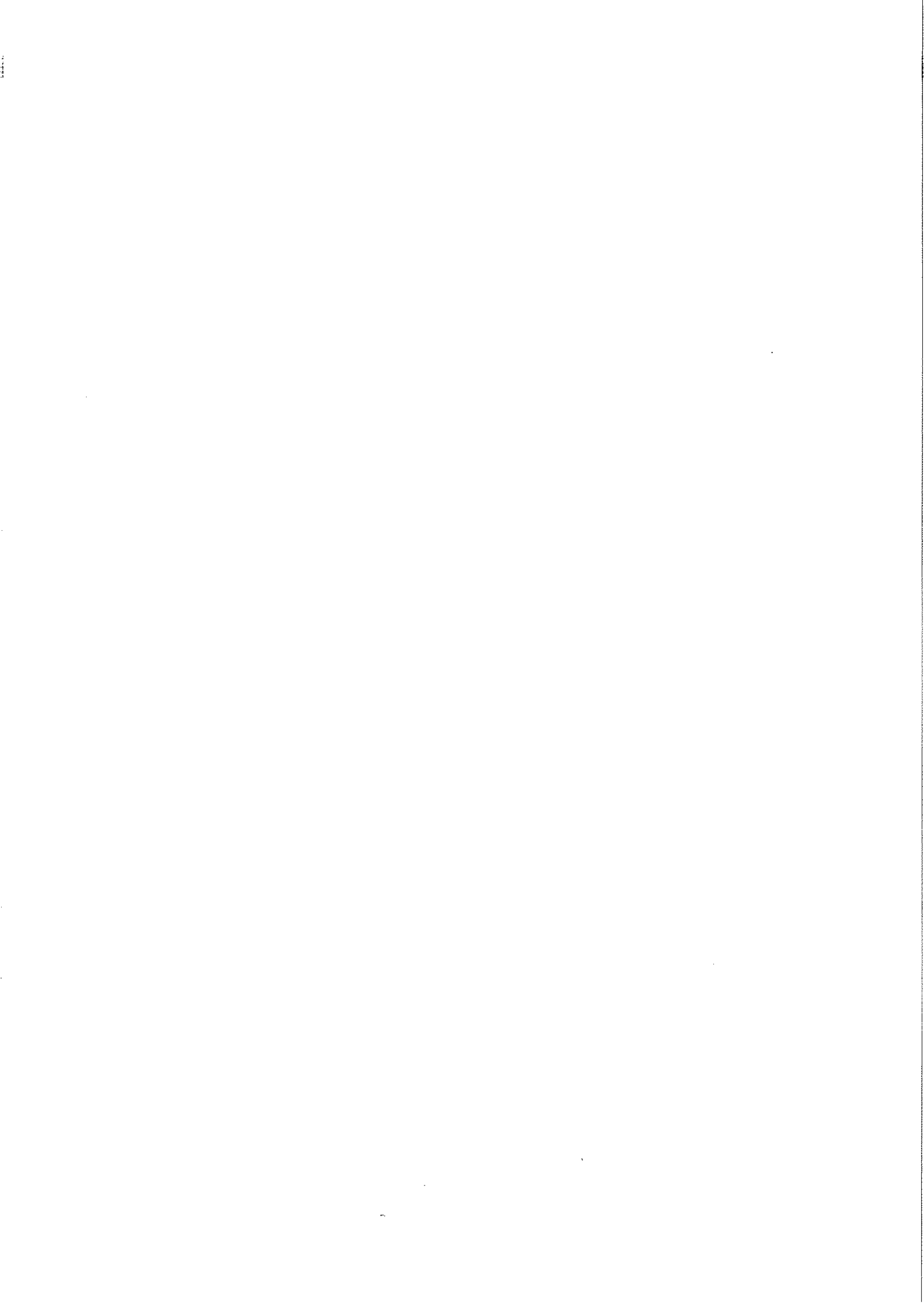

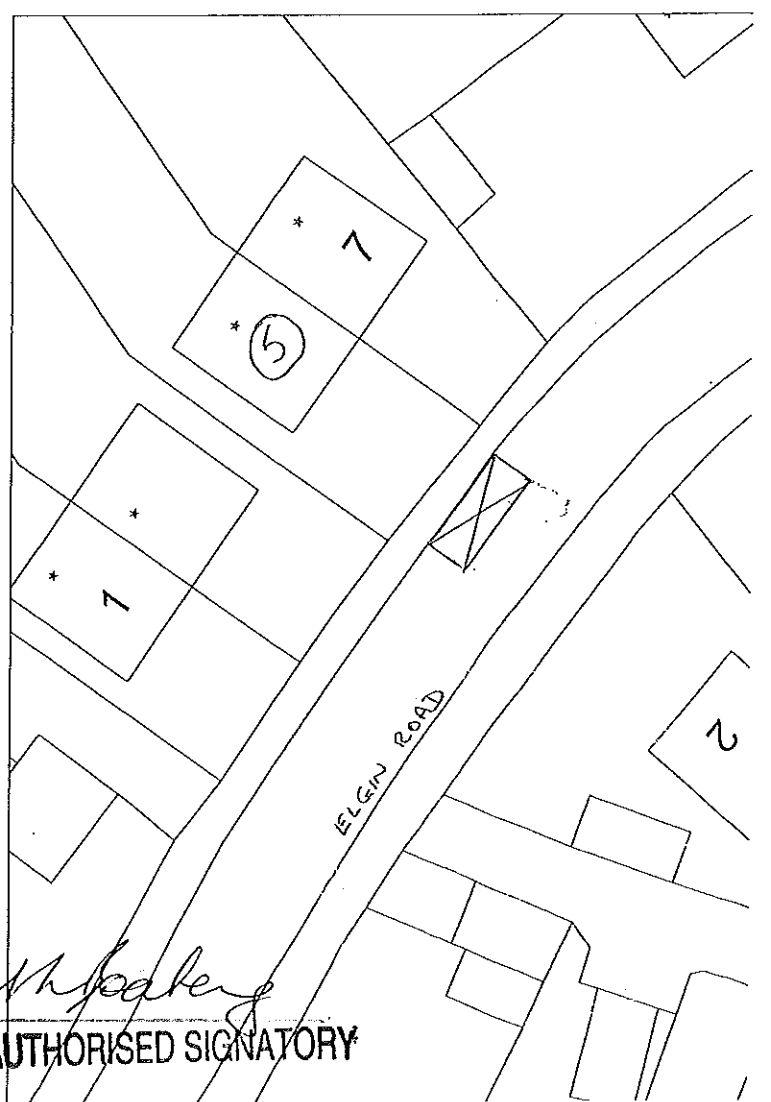
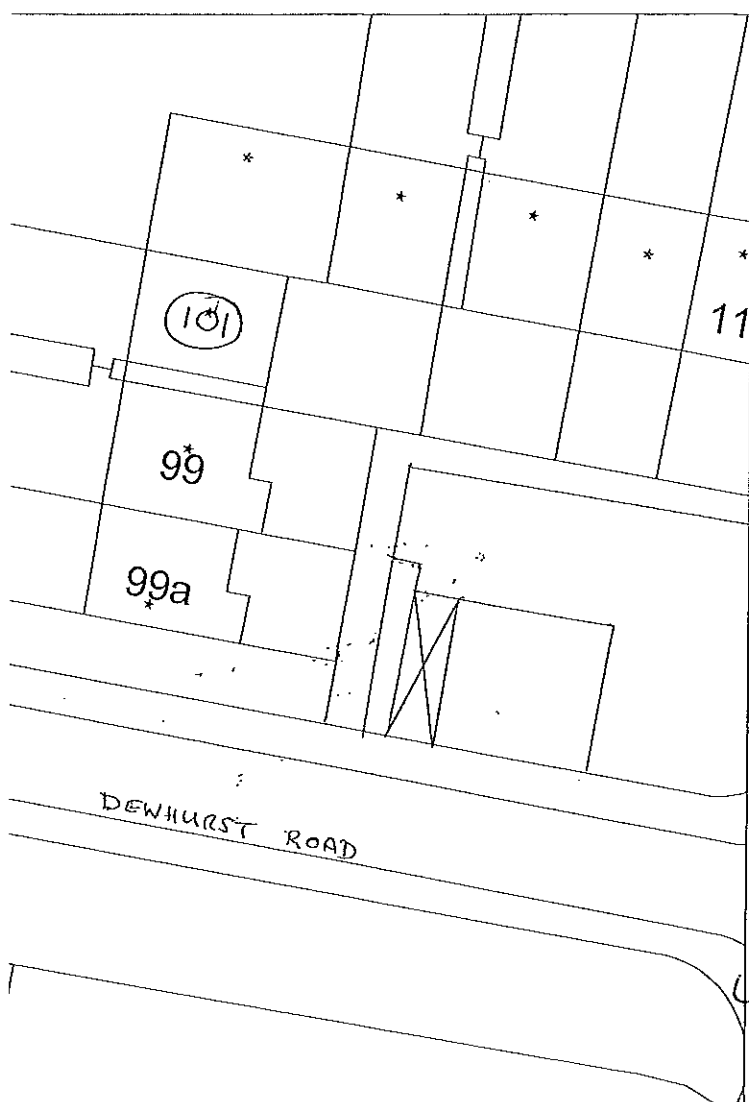
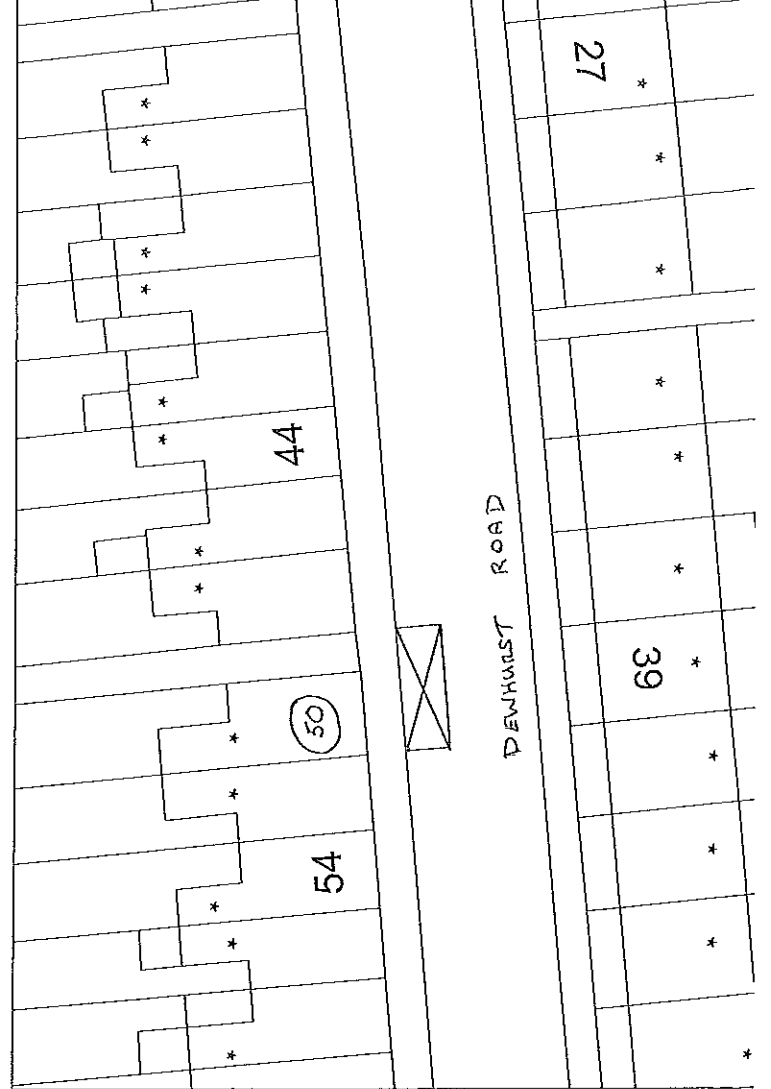
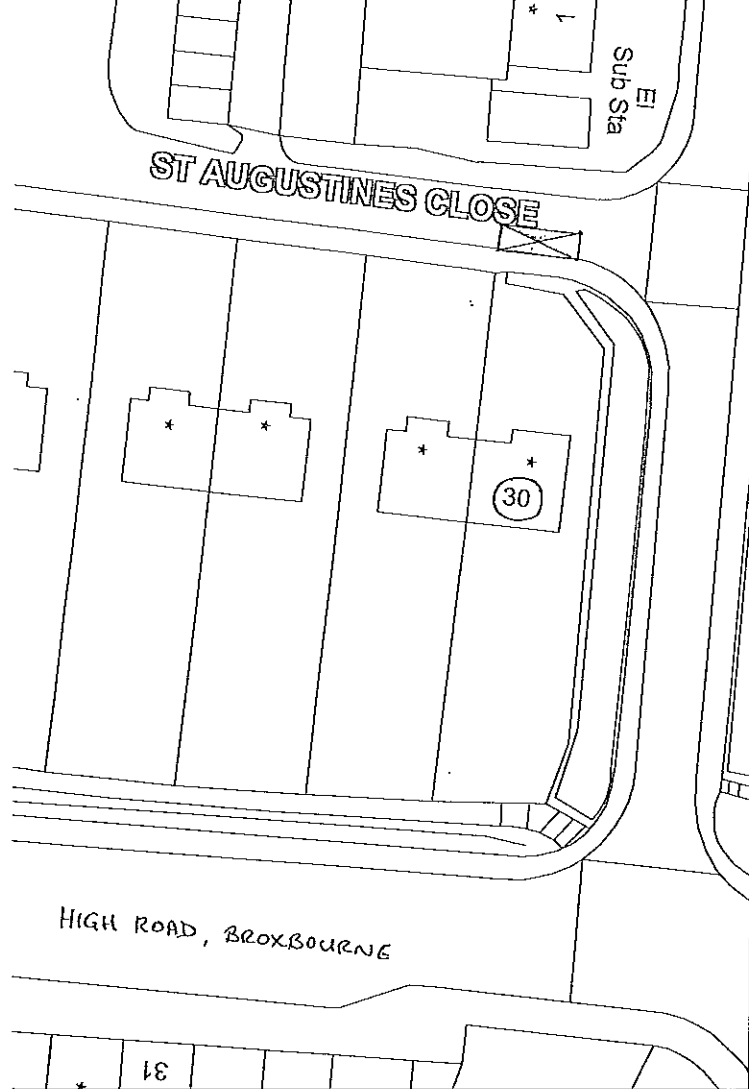

M. Spake
 AUTHORISED SIGNATORY

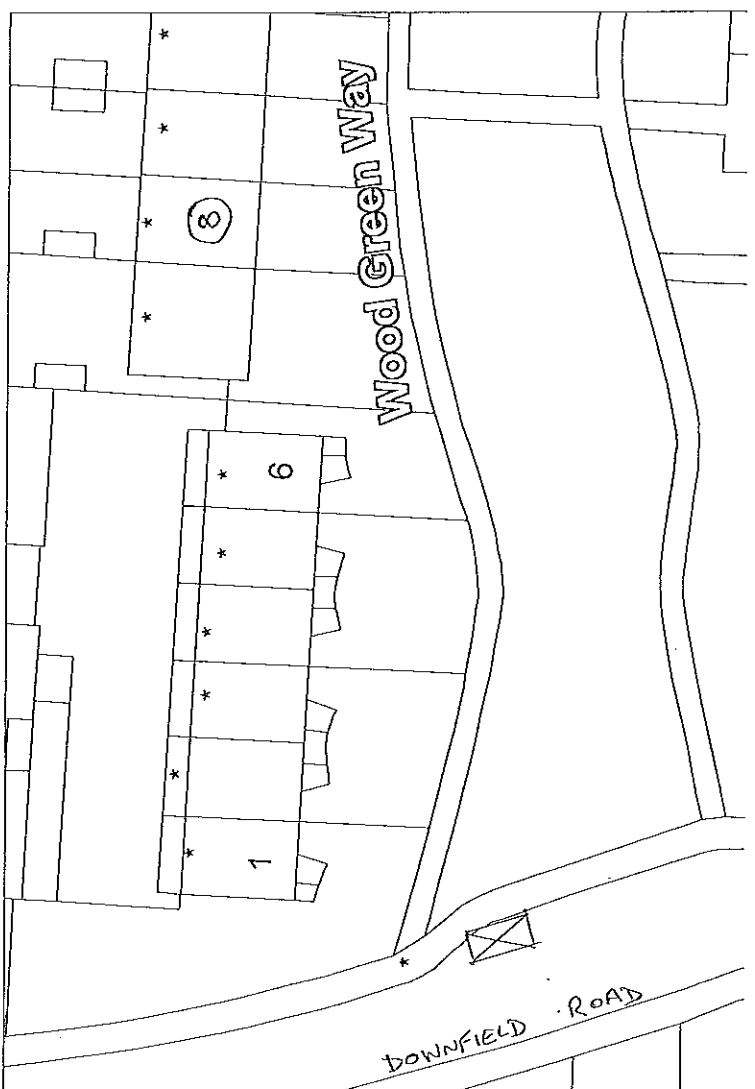
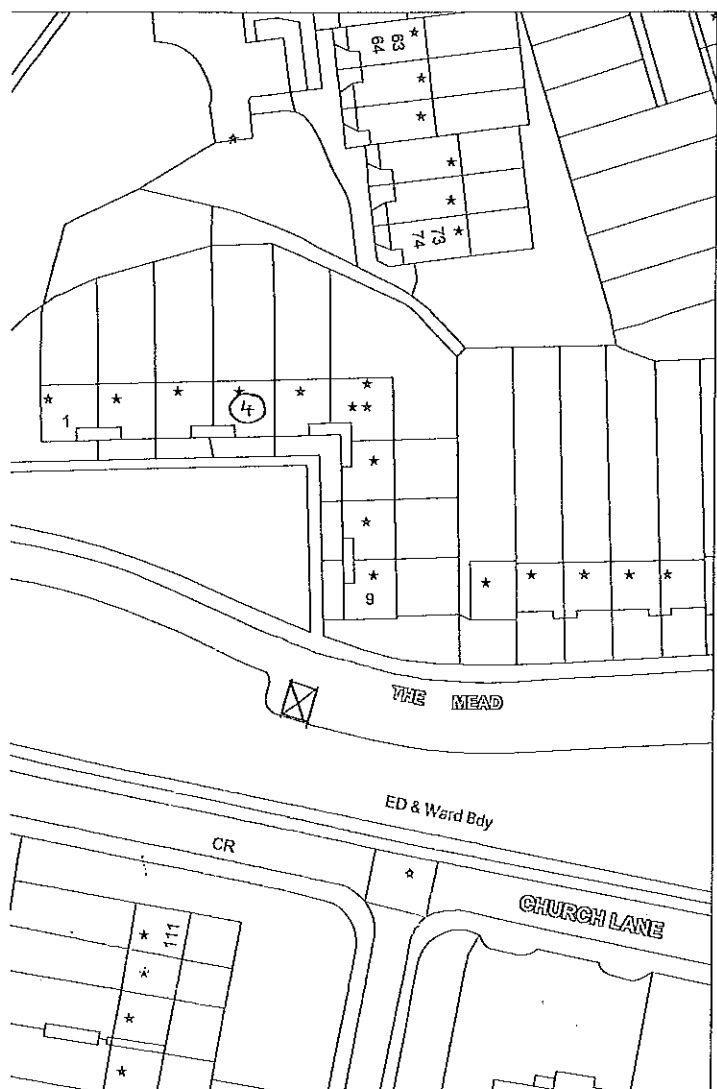
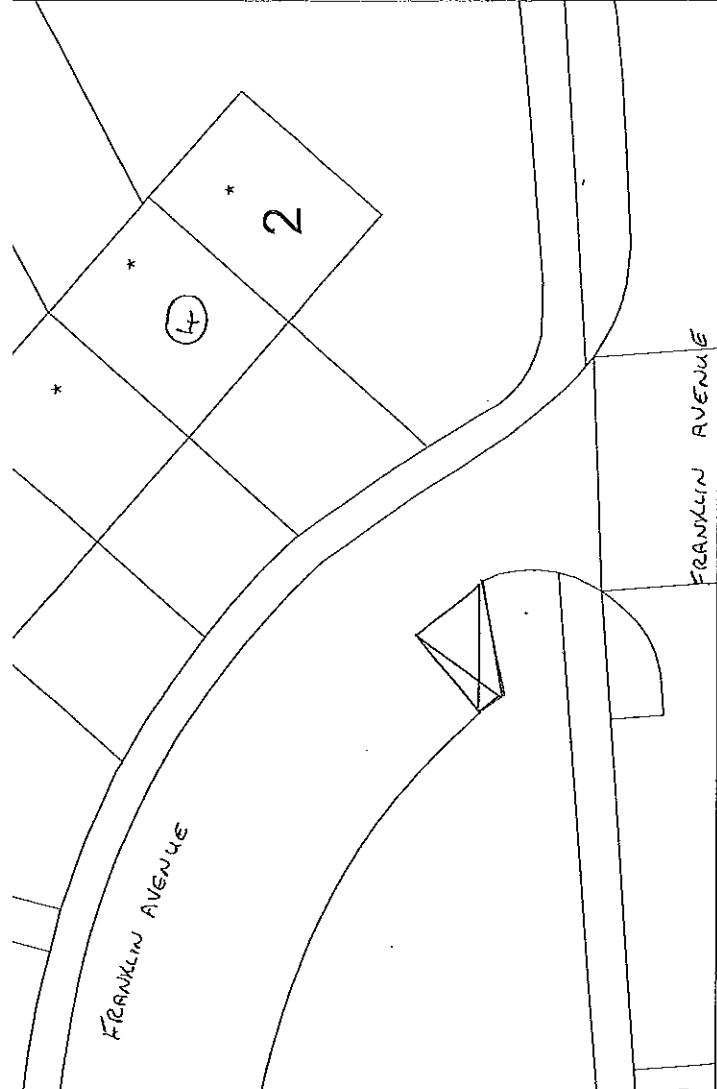

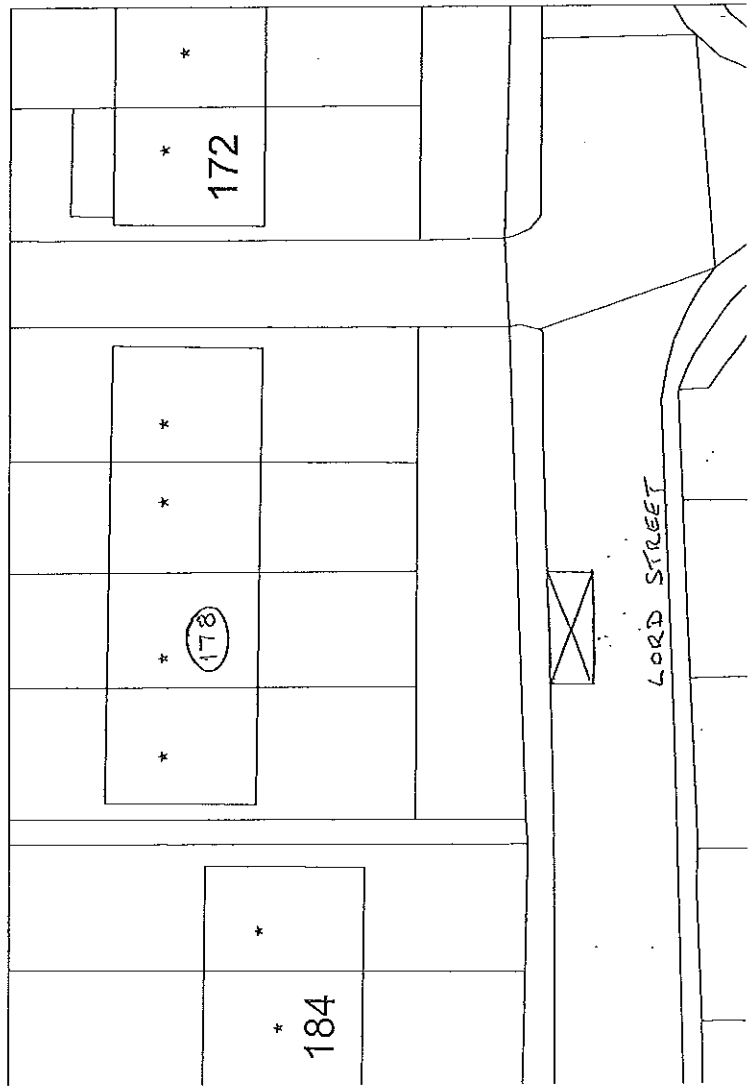
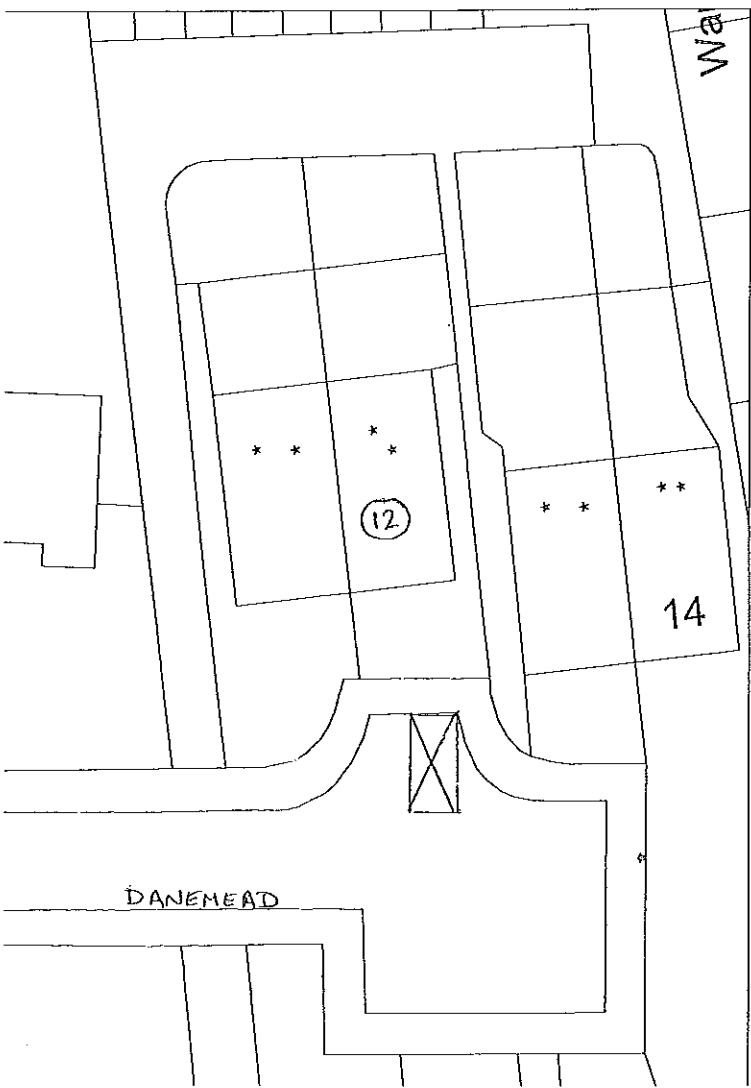
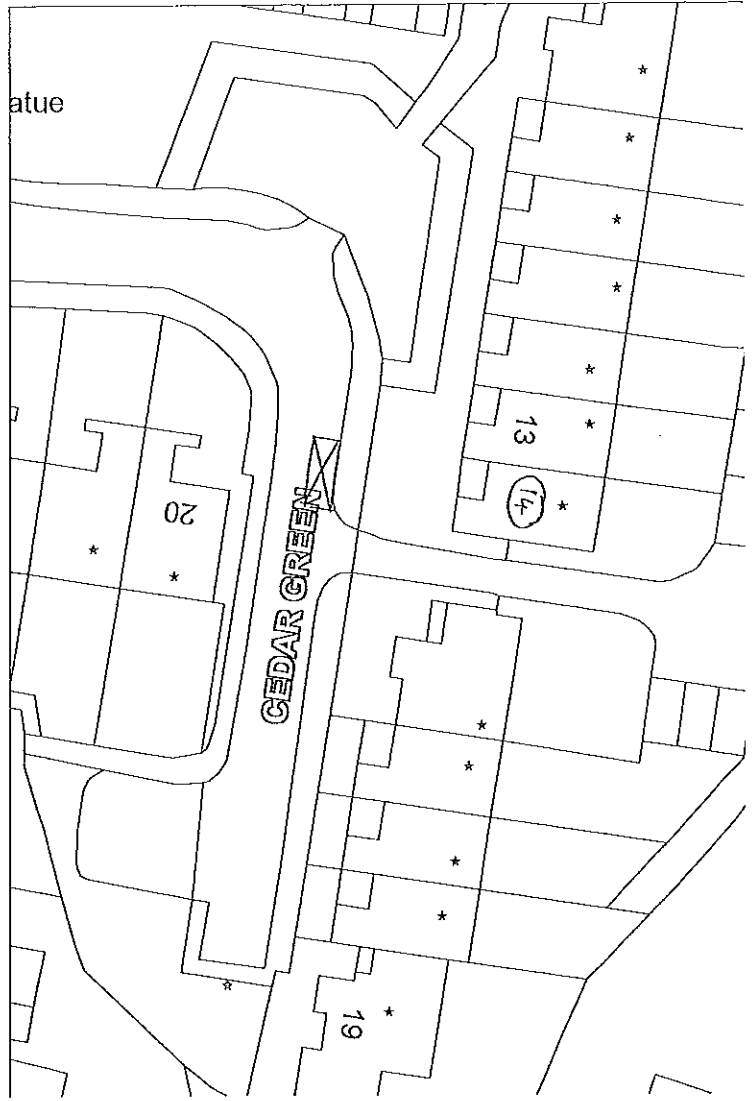
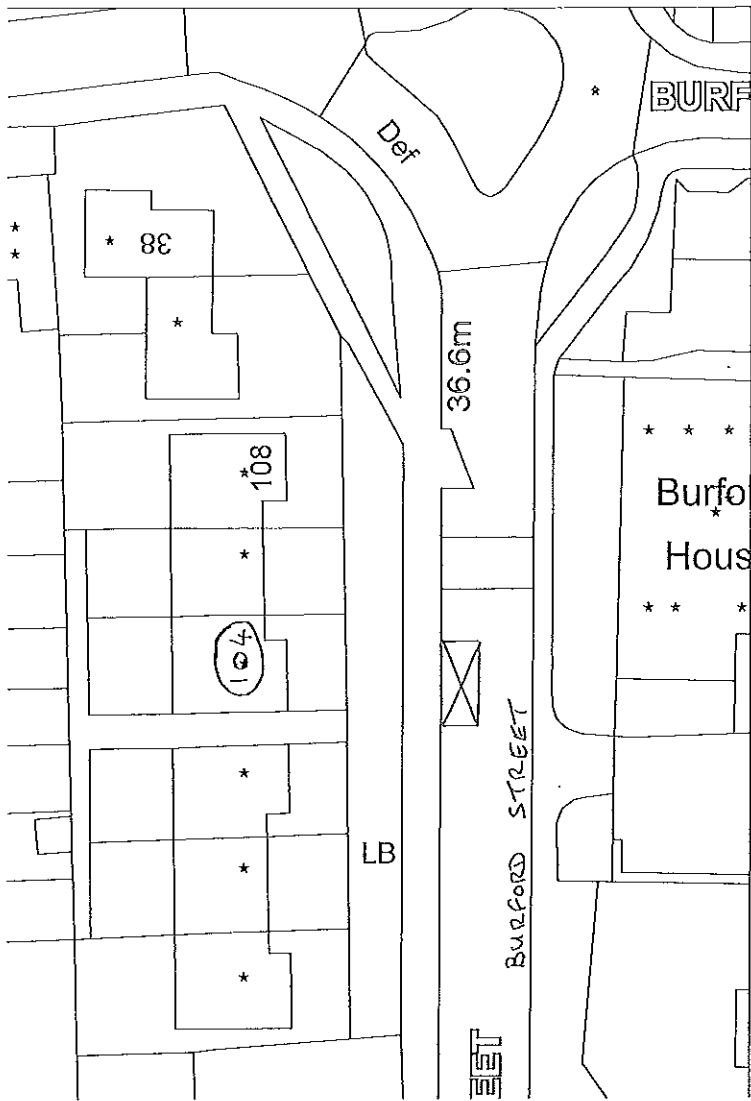

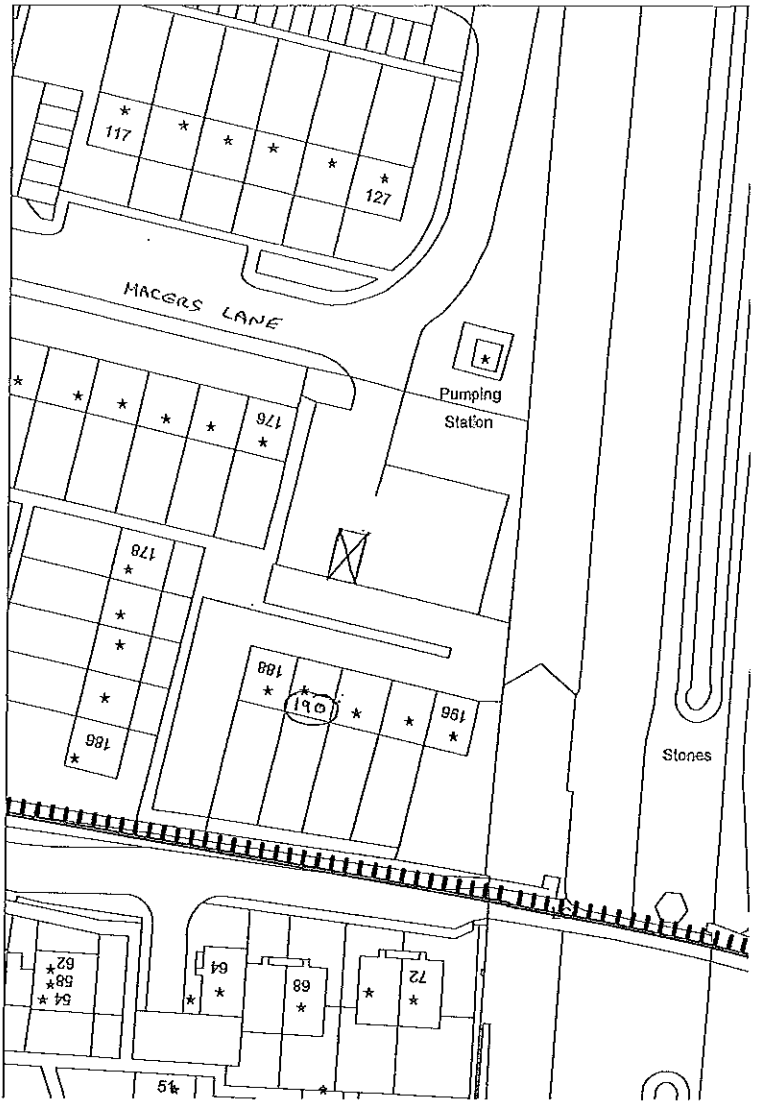
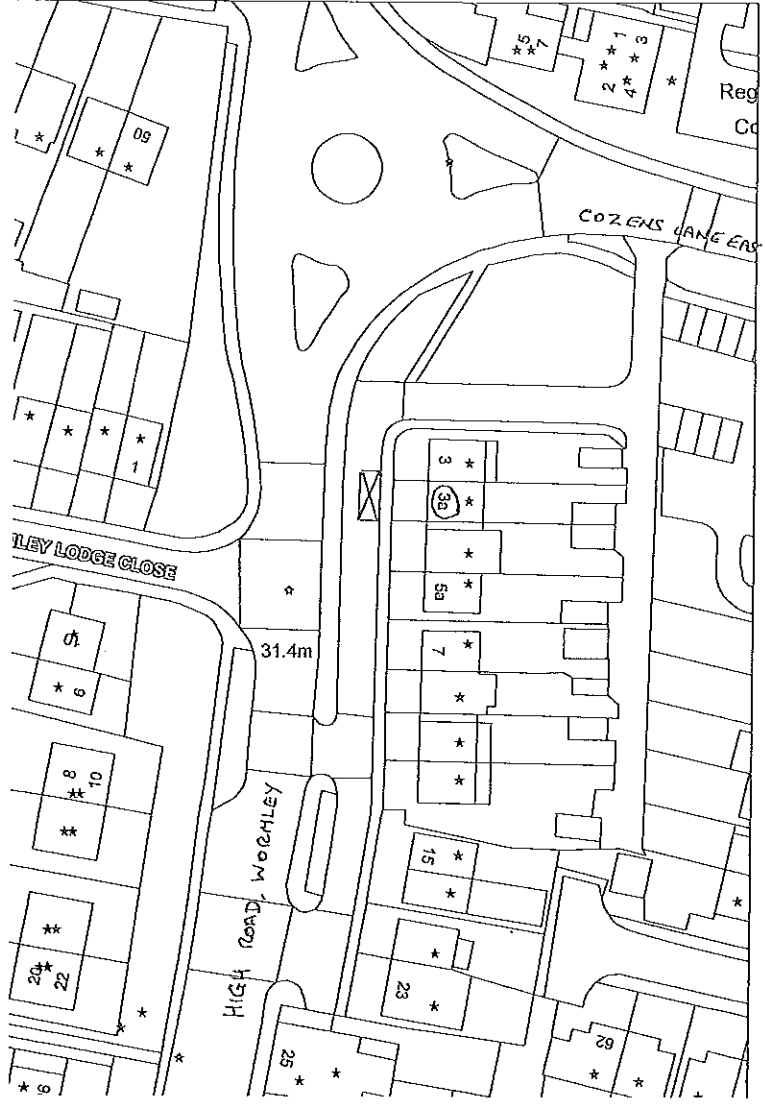

IN WITNESS whereof the Common Seal of the Council of the Borough of Broxbourne has hereunto been affixed on this 1st May 2015

The Common Seal of the COUNCIL OF THE BOROUGH OF BROXBOURNE was hereunto affixed in the presence of:-



M. Soaker
Authorised Signatory

Dated 1st May 2015

ROAD TRAFFIC REGULATION ACT 1984

THE BOROUGH OF BROXBOURNE
(VARIOUS ROADS) (DISABLED
PERSON'S PARKING PLACES)
ORDER 2015