

**BOROUGH OF BROXBOURNE**  
**ROAD TRAFFIC REGULATION ACT 1984**

**THE BOROUGH OF BROXBOURNE (VARIOUS ROADS)**  
**(DISABLED PERSONS' PARKING PLACES) ORDER No. 2017**

**THE COUNCIL OF THE BOROUGH OF BROXBOURNE**, pursuant to arrangements made with the Hertfordshire County Council under Section 19 of the Local Government Act 2000 and the Local Authorities (Arrangements for the Discharge of Functions) (England) Regulations 2012, and in exercise of its powers under Sections 32 and 35 of the Road Traffic Regulation Act 1984, (hereinafter called "the 1984 Act") and of all other enabling powers, and after consultation with the Chief Officer of Police in accordance with Part III of Schedule 9 of the Act of 1984, hereby make the following Order:

1(1) In this Order

"Disabled Person's Badge" has the same meaning as in The Local Authorities' Traffic Orders (Exemptions for Disabled Persons) (England) Regulations 2000.

"Disabled Person's Vehicle" has the same meaning as in Section 142(1) of the 1984 Act

"Driver", in relation to a vehicle waiting in a Parking Place, means the person driving the vehicle at the time it was left in the Parking Place

"Parking Place" means any part of a road authorised by this Order to be used as a parking place

(2) For the purposes of this Order a vehicle shall be regarded as displaying a Disabled Person's Badge in the relevant position if:

- (i) in the case of a vehicle fitted with a dashboard or fascia panel, the badge is exhibited thereon so that the serial number and the date of expiry of the badge is legible from outside the vehicle; or
- (ii) in the case of a vehicle not fitted with a dashboard or fascia panel, the badge is exhibited in a conspicuous position on the vehicle so that the serial number and the date of expiry of the badge is legible from outside the vehicle.

2(1) Those parts of the roads specified in Column 1 of Schedule 1 and shown for identification purposes only in the plan in the Schedule to this Order are authorised to be used in a position specified in Column 2 of the said Schedule 1 and subject to the following provisions of this Order, as Parking Places at any time for Disabled Person's Vehicles which display in the relevant position a Disabled Person's Badge.

(2) Nothing in paragraph (1) of this Article shall restrict the power of the Council, for preventing obstruction of the roads, by order, or by notice on the occasion of any public procession, rejoicing or illumination, or when the roads are thronged or liable to be obstructed, to close the Parking Place.

3 Where in Column 1 of Schedule 1 to this Order a Parking Place is described as available for a Disabled Person's Vehicle which displays in the relevant position a Disabled Person's Badge, the Driver of a vehicle shall not permit it to wait in that Parking Place unless it is:

- (a) a Disabled Person's Vehicle on which is displayed in the relevant position a Disabled Person's Badge, and
- (b) wholly within the limits of the Parking Place.

- 4 A Driver of a vehicle shall not use a Parking Place:-
  - (a) so as unreasonably to prevent access to any premises adjoining the road, or the use of the road by other persons, or so as to be a nuisance;
  - (b) when for preventing obstruction of the road the Council shall by order or by notice made on the occasion of any public procession, rejoicing or illumination or when the roads are thronged or liable to be obstructed have closed that Parking Place and exhibited notice of such closing on or near the Parking Place.
- 5 The Driver of a motor vehicle using a Parking Place shall stop the engine as soon as the vehicle is in a position in the Parking Place, and shall not start the engine except when about to change the position of the vehicle in or to depart from the Parking Place.
- 6 No person shall use a vehicle, while it is in a Parking Place, in connection with the sale of any article to persons in or near the Parking Place or in connection with the selling or offering for hire of his skill or service.
- 7 Subject to the provision hereto, when a vehicle is left in a Parking Place in contravention of any of the provisions contained in Articles 3 and 4 of this Order a person authorised in that behalf by the Council may remove the vehicle or arrange for it to be removed from that Parking Place provided that when a vehicle is waiting in a Parking Place in contravention of the provisions of Articles 3 and 4 of this Order, a person authorised in that behalf by the Council may alter or cause to be altered the position of the vehicle in order that its position shall comply with that provision.
- 8 Any person removing a vehicle or altering its position by virtue of Article 7 of this Order may do so by towing or driving the vehicle or moving the vehicle in such other manner as he may think necessary and may take such measures in relation to the vehicle as he may think necessary to enable him to remove it or alter its position, as the case may be.
- 9 When a person authorised by the Council removes or makes arrangements for the removal of a vehicle from a Parking Place by virtue of Article 7 of this Order, he shall make such arrangements as may be reasonably necessary for safe custody of the vehicle.
- 10 The lengths of road specified in Schedule 2 of this Order are no longer authorised for the sole parking of disabled persons vehicles.
- 11 The provisions of The Borough of Broxbourne (Control of Parking) (Consolidation) Order 2013 ("the 2013 Order") are hereby revoked but only in so far as they are affected by the restrictions imposed by this Order.
- 12 Paragraph 9 & 11 of Schedule 1 of the Borough of Broxbourne (Various Roads) (Disabled Persons Parking Places) Order No. 2014 is revoked.
- 13 Paragraphs 38 & 40 of Schedule 1 of the Borough of Broxbourne (Various Roads) (Disabled Persons Parking Places) Order No. 2 2014 is revoked.
- 14 Paragraphs 10 & 17 of Schedule 1 of the Borough of Broxbourne (Various Roads) (Disabled Persons Parking Places) Order No. 2015 is revoked.
- 15 Paragraphs 2 & 16 of Schedule 1 of the Borough of Broxbourne (Various Roads) (Disabled Persons Parking Places) Order No. 2 2015 is revoked.

- 16 Paragraphs 10 of Schedule 1 of the Borough of Broxbourne (Various Roads) (Disabled Persons Parking Places) Order No. 2016 is revoked.
- 17 Paragraphs 7 & 10 of Schedule 1 of the Borough of Broxbourne (Various Roads) (Disabled Persons Parking Places) Order No. 2 2016 is revoked.
- 18 This Order shall come into operation on 11th May 2017 and may be cited as the Borough of Broxbourne (Various Roads) (Disabled Persons' Parking Places) Order No 2017.

### SCHEDULE 1

Column 1	Column 2
Description of the Parking Place	Position in which the vehicle may wait
BELLAMY ROAD, CHESHUNT west side from a point 8.0m south of a point in line with the northern flank wall of Nos.59 – 69 Bellamy Road southward for a distance of 5m.	Parallel and adjacent to the kerb
BIRCHFIELD ROAD, CHESHUNT south-west side from a point in line with the northern flank wall of Nos.40 & 42 Birchfield Road south-eastward for a distance of 6m.	Parallel and adjacent to the kerb
CHADWELL AVENUE, CHESHUNT east side from a point 5.5m south of a point in line with the northern flank wall of Nos.72 – 82 Chadwell Avenue southward for a distance of 6m.	Parallel and adjacent to the kerb
DOWNFIELD ROAD, CHESHUNT north side from a point 7.0m east of a point in line with the western flank wall of Nos.127-137 Downfield Road eastward for a distance of 6.0m	Parallel and adjacent to the kerb
ELDERBEK CLOSE, CHESHUNT north side from a point 9.0m east of a point in line with the western flank wall of Nos.30 & 32 Elderbek Close westward for a distance of 2.4m	Lengthwise at 90° to the kerb in a North / South direction
ELDERBEK CLOSE, CHESHUNT north side from a point 16.6m west of a point in line with the eastern flank wall of Nos.80 – 82 Elderbek Close westward for a distance of 2.4m.	Lengthwise at 90° to the kerb in a North / South direction
ELDERBEK CLOSE, CHESHUNT east side from a point 6.5m north of a point in line with the northern flank wall of No. 66 Elderbek Close northward for a distance of 5.0m.	Parallel and adjacent to the kerb

LAKESIDE ROAD, CHESHUNT north side from a point 1.0m west of a point in line with the boundary wall between Nos.13 & 15 Lakeside Road, Cheshunt eastward for a distance of 2.4m.	Lengthwise at 90° to the kerb in a North / South direction
MAYO CLOSE, CHESHUNT south side from a point 3.2m east of a point in line with the western flank wall of Nos.10 – 16 Mayo Close eastward for a distance of 6.0m	Parallel and adjacent to the kerb
SHAW CLOSE, CHESHUNT west side from a point 1.0m south of a point in line with the boundary between Nos.17-20 & 21-24 Shaw Close southwards for a distance of 3.0m	Lengthwise at 45° to the kerb in a North-West / South-East direction
CATHROW MEWS, HODDESDON west side from a point in line with the boundary between Nos.10 & 11 Cathrow Mews southward for a distance of 2.75m.	Lengthwise at 90° to the kerb in a West / East direction
LABURNUM ROAD, HODDESDON west side from a point 3.0m north of a point in line with the north-eastern flank wall of No. 45 Lilac Road southward for a distance of 6.0m	Parallel and adjacent to the kerb
LAMPITS, HODDESDON east side from a point 4.8m north of a point in line with the front wall of No.101 Lampits northward for a distance of 2.5m.	Lengthwise at 90° to the kerb in a East / West direction
LORD STREET, HODDESDON south side from a point in line with the western boundary wall between Nos.139 & 141 Lord Street eastward for a distance of 6.0m.	Parallel and adjacent to the kerb
MIDDLEFIELD ROAD, HODDESDON south side from a point in line with the boundary between Nos.35 & 37 Middlefield Road westward for a distance of 6.0m.	Parallel and adjacent to the kerb
RYE ROAD, HODDESDON north side from a point in line with the boundary between Nos. 74 & 76 Rye Road eastward for a distance of 5.5m.	Parallel and adjacent to the kerb
RYE ROAD, HODDESDON north side from a point in line with the boundary between Nos.180 & 182 Rye Road westward for a distance of 6.0m.	Parallel and adjacent to the kerb
SAFFRON CLOSE, HODDESDON south side from a point 6.0m east of a point in line with the western flank wall of Nos.9 &10 Saffron Close eastward for a distance of 2.5m.	Lengthwise at 90° to the kerb in a North / South direction
THE KNOWLE, HODDESDON west side from a point 3.8m north of a point in line with the southern flank wall of Nos.20 – 25 The Knowle northward for a distance of 6.0m	Parallel and adjacent to the kerb

WALNUT TREE CLOSE, HODDESDON south side from a point in line with the eastern flank wall of Nos.23 – 27 Walnut Tree Close westward for a distance of 2.4m.	Lengthwise at 90° to the kerb in a North / South direction
WESTFIELD ROAD, HODDESDON north side from a point 1.5m west of a point in line with the eastern front wall of No.53 Hertford Road eastward for a distance of 6.0m	Parallel and adjacent to the kerb
BERKLEY AVENUE, WALTHAM CROSS north side from a point in line with the boundary between Nos.89 & 91 Berkley Avenue eastward for a distance of 5.0m.	Parallel and adjacent to the kerb
ELEANOR ROAD, WALTHAM CROSS south side from a point 1.2m east of a point in line with the western flank wall of No.84 Eleanor Road eastward for a distance of 5.0m.	Parallel and adjacent to the kerb
SWANFIELD ROAD, WALTHAM CROSS north side from a point in line with the boundary between Nos.29 & 31 Swanfield Road westward for a distance of 5.5m.	Parallel and adjacent to the kerb

## SCHEDULE 2

### Description of those parking places to be removed

- Barrow Lane, Cheshunt south side from a point 2.0m west of a point in line with the boundary between Nos.109 & 111 Barrow Lane eastward for a distance of 6 metres.
- Burbage Close, Cheshunt north side from a point 8.0m west of a point in line with the western flank wall of No.1 Burbage Close westward for a distance of 6 metres.
- Chadwell Avenue, Cheshunt south side from a point 4.0m east of a point in line with the western flank wall of No.20 Chadwell Avenue westward for a distance of 6.0 metres.
- Clarendon Road, Cheshunt north side from a point in line with the boundary between Nos.6 & 8 Clarendon Road eastward for a distance of 5.4 metres.
- Delamare Road, Cheshunt west side from a point in line with the northern flank wall of No.20 Delamare Road southward for a distance of 6 metres.
- Downfield Road, Cheshunt north side from a point 3.55m east of a point in line with the western front wall of No.59 Downfield Road eastward for a distance of 6 metres.
- High Street, Cheshunt west side from a point 1.5m north of a point in line with the northern flank wall of No.140 High Street, Cheshunt northward for a distance of 5.0 metres.
- Holme Close, Cheshunt east side from a point in line with the boundary between Nos.3 & 5 Holme Close southward for a distance of 2.5 metres.
- Kingsley Avenue, Cheshunt north side from a point 3.0m east of a point in line with the western flank wall of No.11 Kingsley Avenue eastward for a distance of 6 metres

Perrysfield Road, Cheshunt east side from a point in line with the boundary between Nos. 123 & 125 Perrysfield Road northward for a distance of 6 metres.

Russells Ride, Cheshunt east side from a point 1.9m south of a point in line with the northern flank wall of Nos. 93 Russells Ride southward for a distance of 2.4 metres

Smarts Green, Cheshunt south side from a point 12.4m west of a point in line with eastern flank wall of No. 45 Smarts Green westward for a distance of 2.5 metres.

Cedar Green, Hoddesdon east side from a point in line with the boundary between Nos. 13 & 14 Cedar Green southward for a distance of 6 metres.

Foxton Road, Hoddesdon south side from a point 5.0m west of a point in line with the eastern flank wall of No. 35 Foxton Road westward for a distance of 6.0 metres.

Murchison Road, Hoddesdon north side from a point 0.5m west of a point in line with the boundary between Nos. 18 & 20 Murchison Road westward for a distance of 6.0 metres.

North Road, Hoddesdon west side from a point 1.9m south of a point in line with the boundary between Nos. 26 & 28 North Road northward for a distance of 5.5 metres.

Old Essex Road (formerly Essex Road), Hoddesdon north side from a point 3.0m west of a point in line with the boundary between Nos. 64 & 66 Old Essex Road eastward for a distance of 6.0 metres.

Rye Road, Hoddesdon north side from a point in line with the eastern flank wall of No. 68 Rye Road westward for a distance of 6.0 metres.

Winterscroft Road, Hoddesdon north side from a point 2.5m southwest of a point in line with the eastern flank wall of Nos. 18 & 20 Winterscroft Road north-eastwards for a distance of 2.5 metres.

Broomfield Avenue, Turnford south side from a point 2.4m west of a point in line with the northern flank wall of No. 33 Broomfield Avenue westward for a distance of 2.4 metres.

Cornwall Close, Waltham Cross east side from a point 1.0m north of a point in line with northern flank wall of No. 3 Cornwall Close southward for a distance of 6 metres.

Kings Road, Waltham Cross south side from a point in line with the rear fence of No. 67 Queens Road eastward for a distance of 5.0 metres.

Queens Road, Waltham Cross west side from a point 0.6m south of a point in line with the boundary between Nos. 31 & 33 Queens Road northward for a distance of 5.5 metres.

Macers Lane, Wormley north side from a point 1.0m west of a point in line with the western flank wall of No. 1 Macers Lane eastward for a distance of 6.0 metres.

Wharf Road, Wormley south side from a point 1.0m east of a point in line with the boundary between Nos. 22 & 24 Wharf Road westward for a distance of 6.0 metres.

53

57

59

63

67

61

65

69

44

BELLAMY ROAD

BIRCHFIELD ROAD

89

64

60

70

66

62

72 to 82

CHADWELL AVENUE

DONNFIELD ROAD

131

139

147

129

137

129

127

135

127

125

08

78

09

*M. Baillie*  
AUTHORISED SIGNATORY

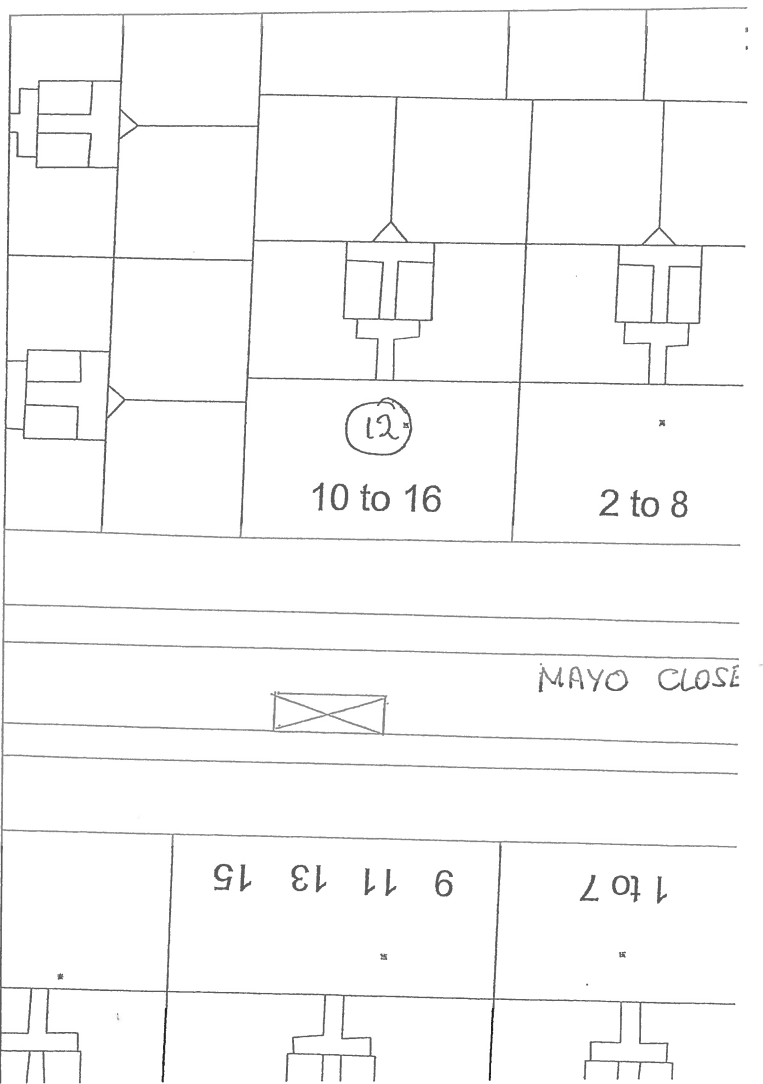
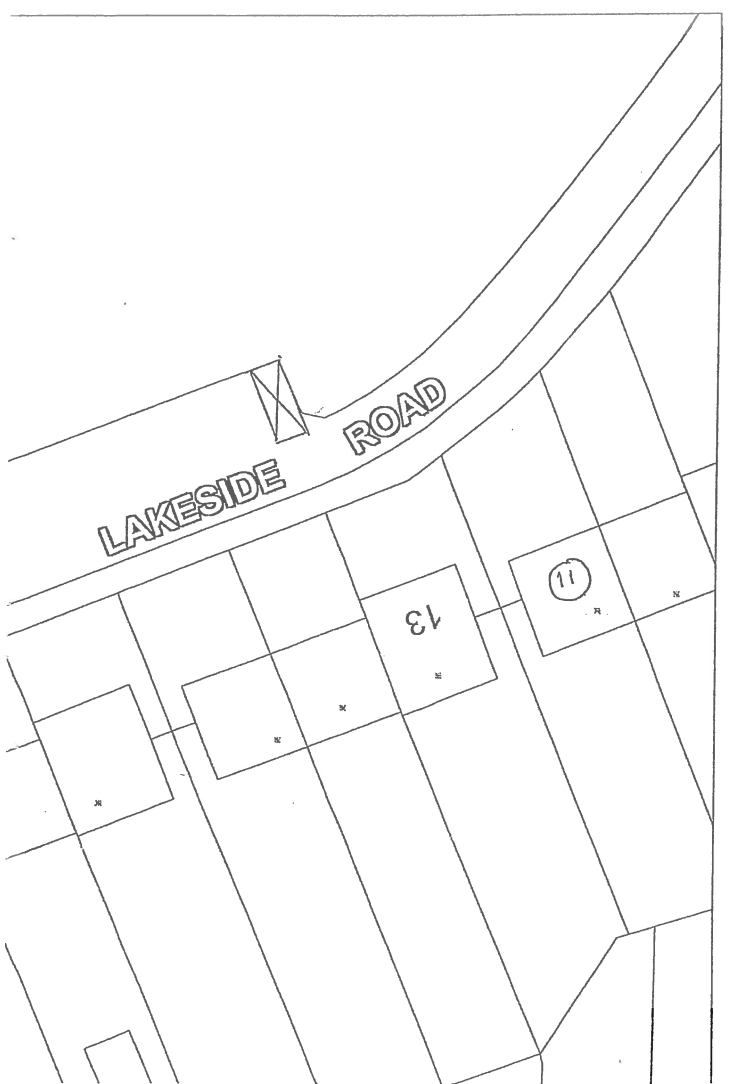
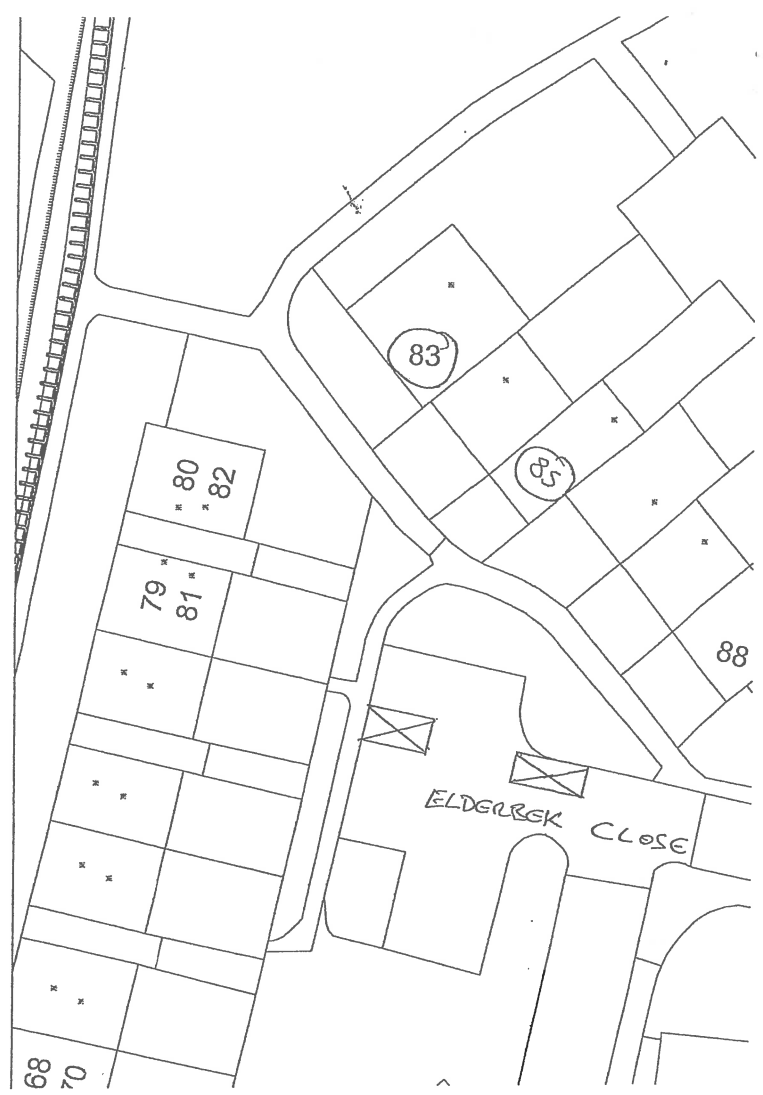
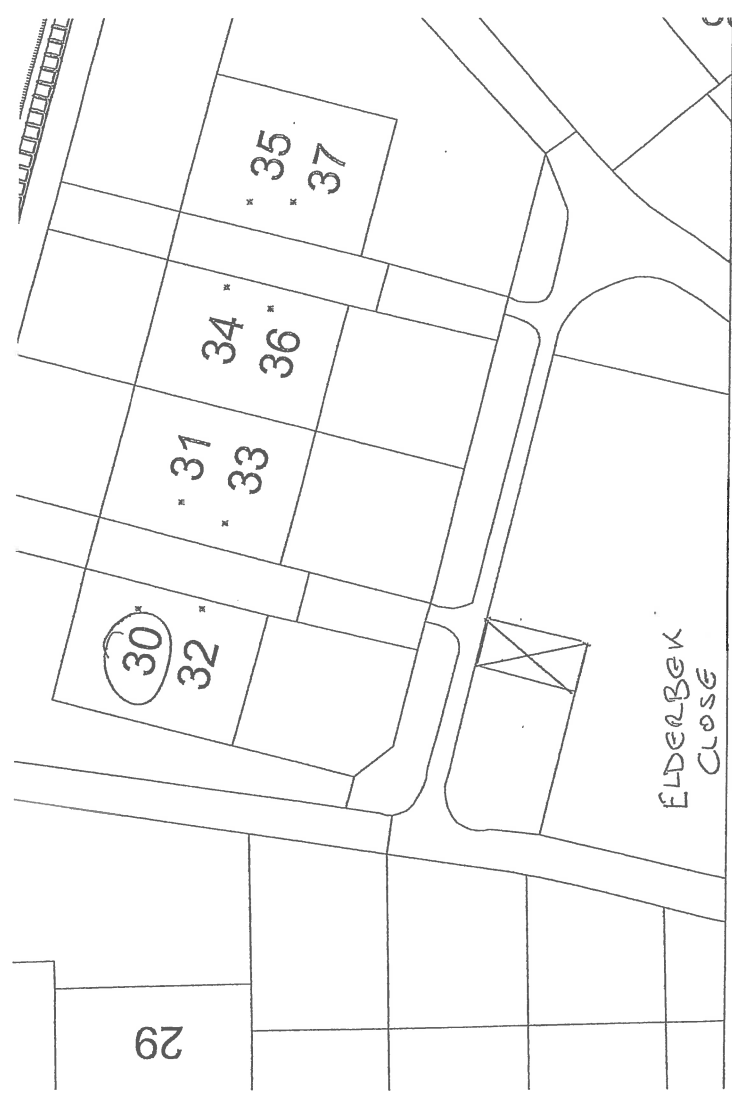



17

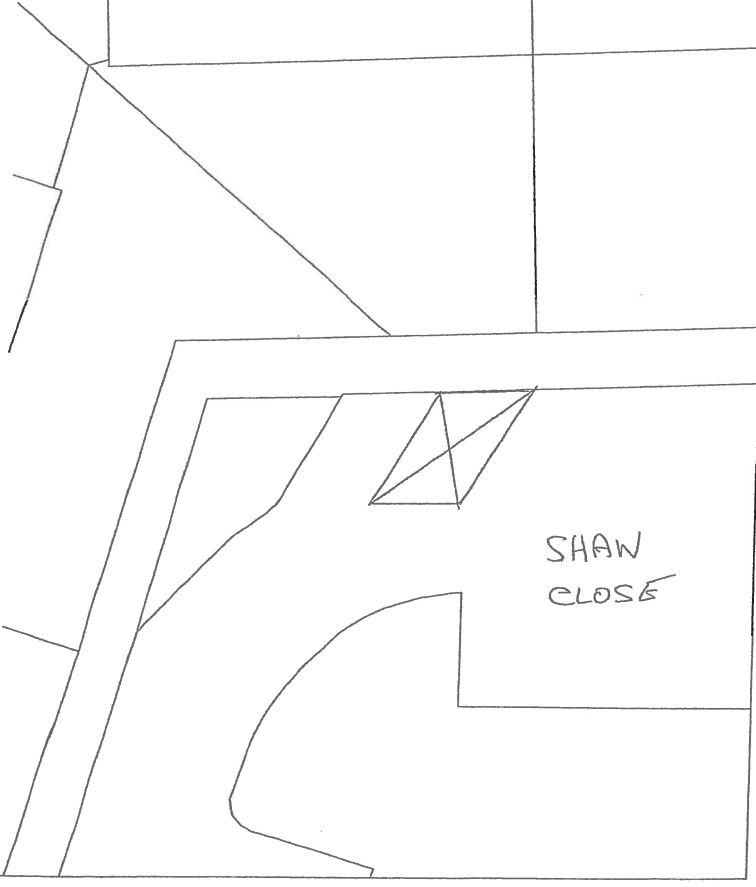

CATHROW MEWS

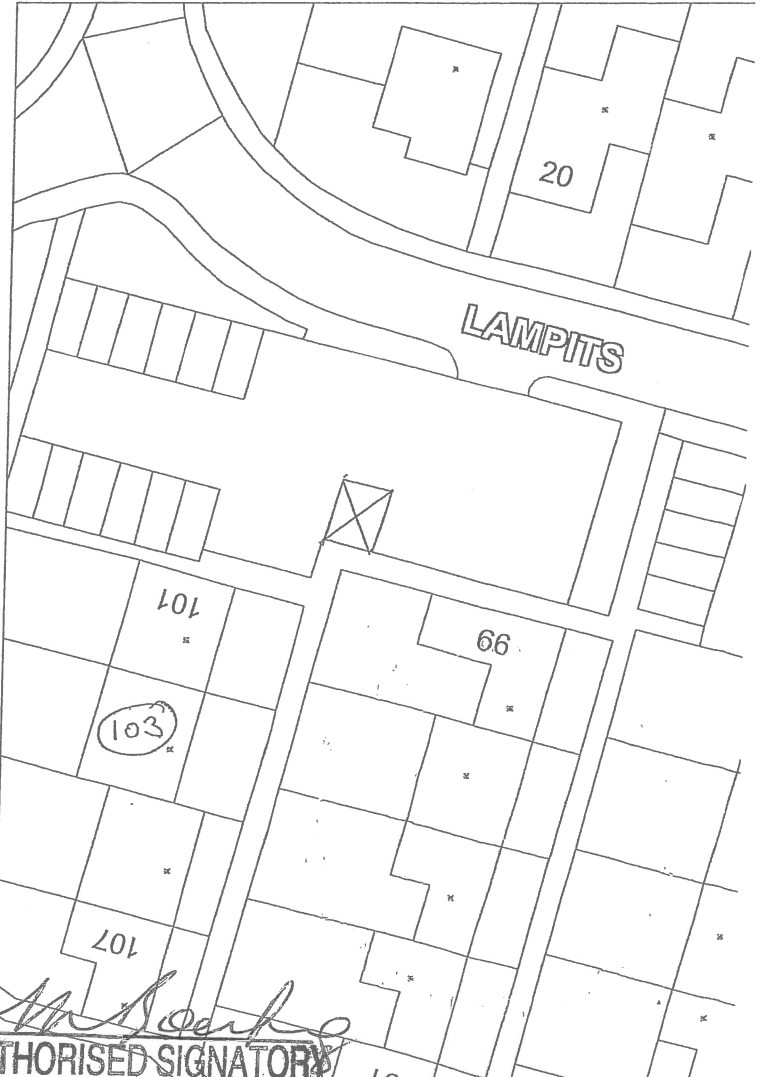
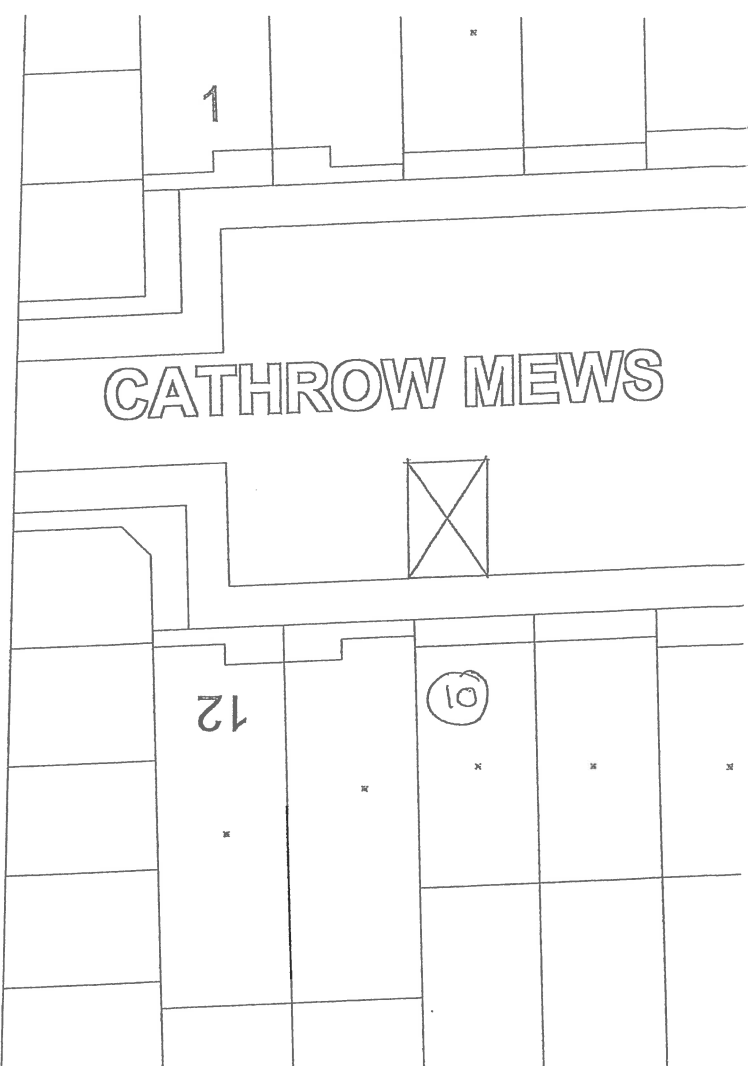

*Mr. [Signature]*  
 AUTHORIZED SIGNATORY

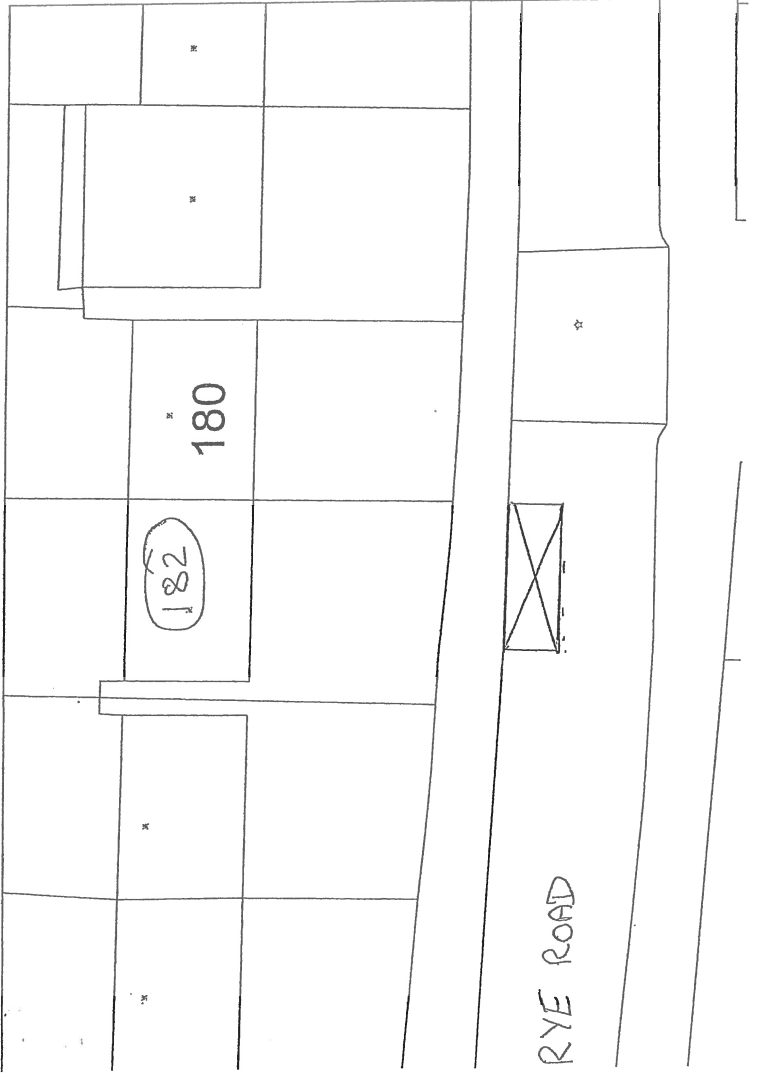

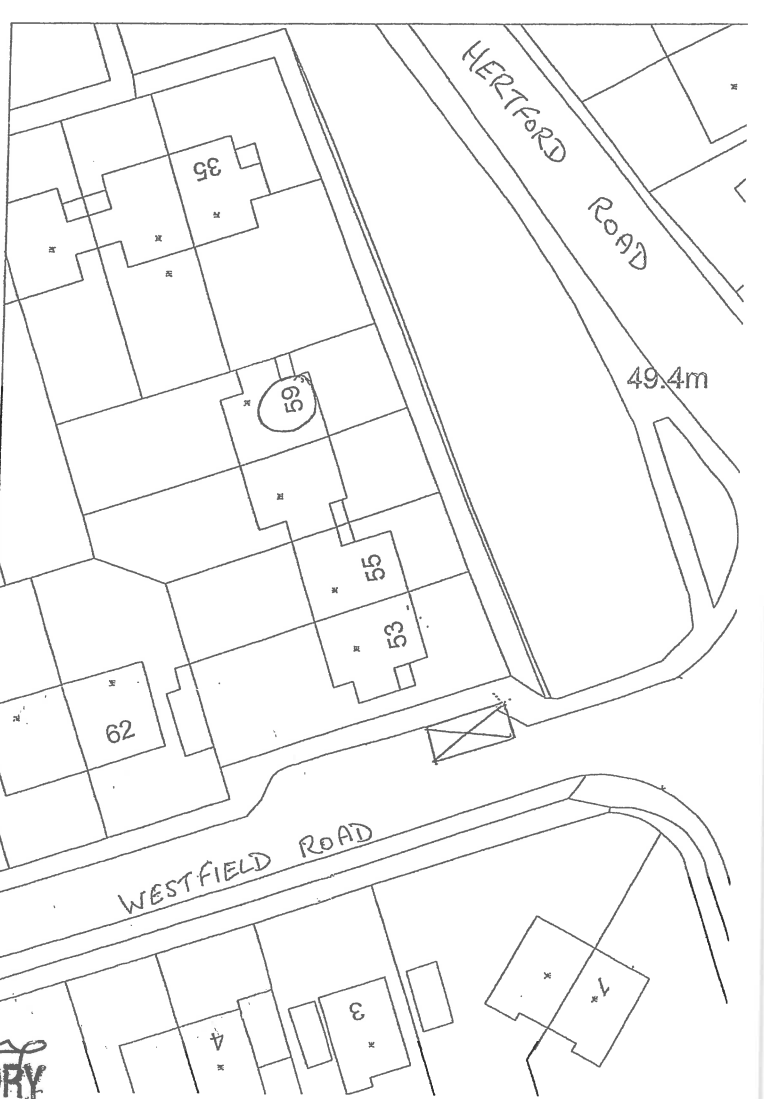
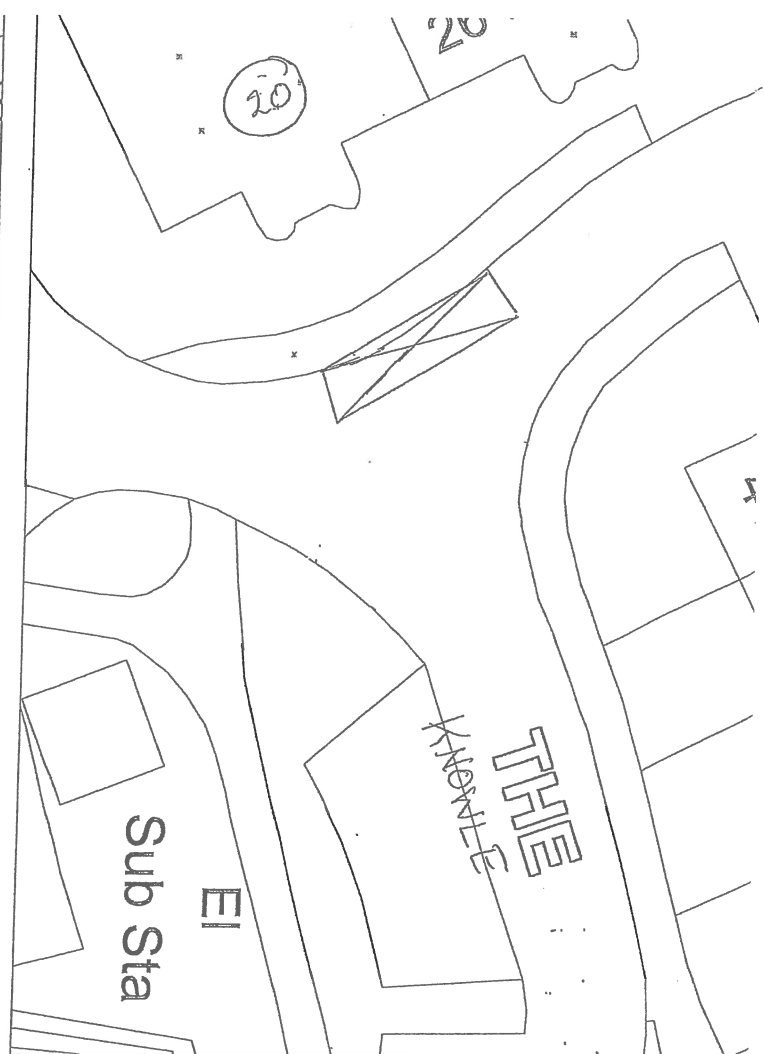

*M. Barber*  
 AUTHORIZED SIGNATORY

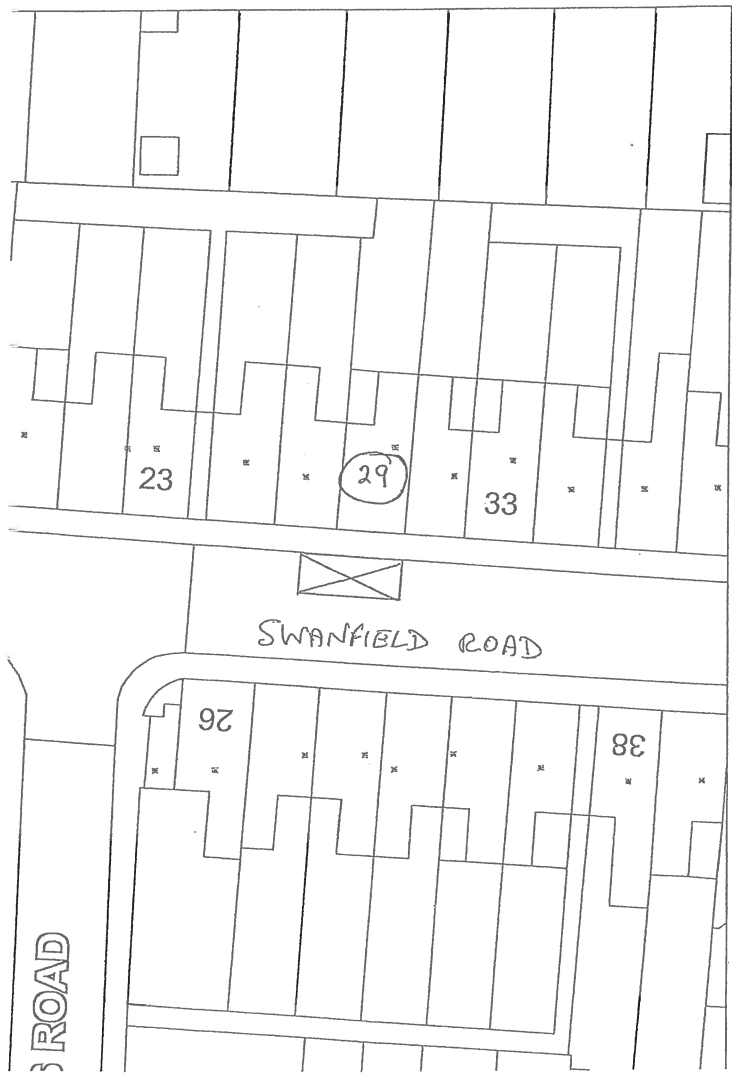
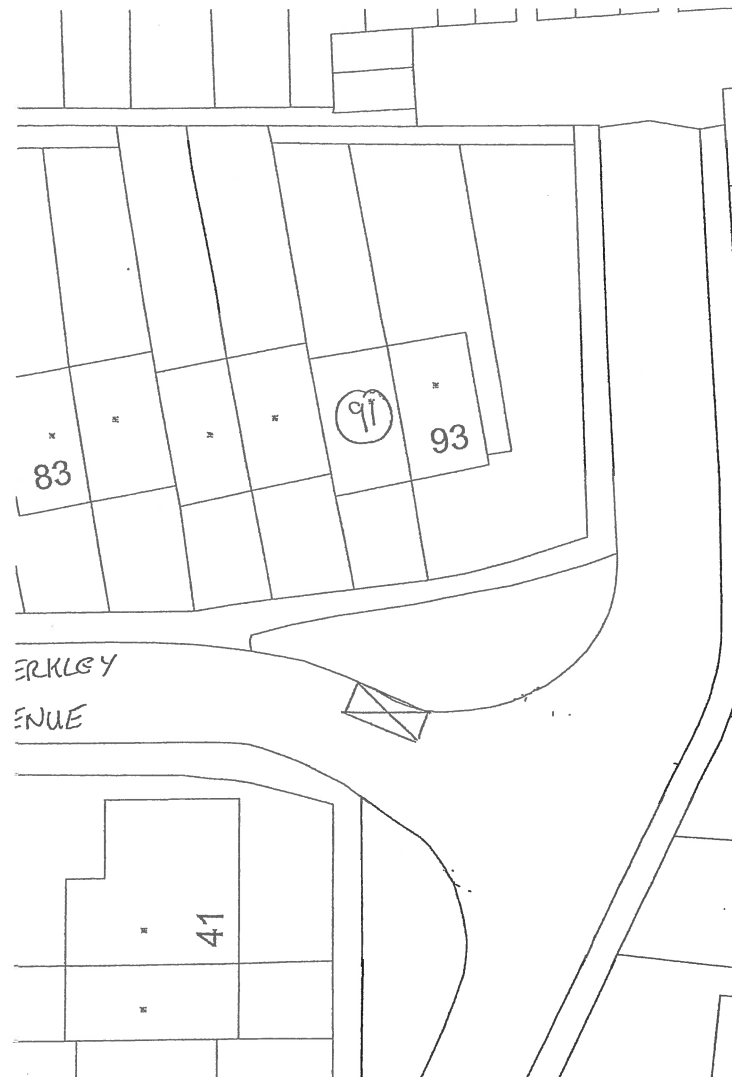

IN WITNESS whereof the Common Seal of the Council of the Borough of Broxbourne has hereunto been affixed on this 8th May 2017

The Common Seal of the COUNCIL OF THE BOROUGH OF BROXBOURNE was hereunto affixed in the presence of:-



A handwritten signature in cursive script, appearing to read 'M. Beatey'.

Authorised Signatory

Dated 8th May 2017

ROAD TRAFFIC REGULATION ACT 1984

THE BOROUGH OF BROXBOURNE  
(VARIOUS ROADS) (DISABLED  
PERSON'S PARKING PLACES)  
ORDER No. 2017



**THE BOROUGH OF BROXBOURNE  
ROAD TRAFFIC REGULATION ACT 1984**

**THE BOROUGH OF BROXBOURNE (VARIOUS ROADS)  
(DISABLED PERSONS' PARKING PLACES) ORDER No. 2017**

**NOTICE** is hereby given that on the 8<sup>th</sup> May 2017 the Council of the Borough of Broxbourne, pursuant to arrangements made with Hertfordshire County Council under Section 19 of the Local Government Act 2000 and the Local Authorities (Arrangements for the Discharge of Functions) (England) Regulations 2012, made an order under Sections 32 and 35 of the Road Traffic Regulations Act 1984, the effect of which is to:

1. Provide Disabled Persons' Parking Places adjacent to or outside the following premises or in the locations indicated if not directly outside the premises as shown;

<u>Premises</u>	<u>Location – if not directly outside Premises</u>
i 59 Bellamy Road, Cheshunt	
ii 44 Birchfield Road, Cheshunt	Outside Nos.40 & 42 Birchfield Road
iii 72 Chadwell Avenue, Cheshunt	
iv 78 Downfield Road, Cheshunt	In lay-by outside Nos.127-129 Downfield Rd
v 30 Elderbek Close, Cheshunt	
vi 83 Elderbek Close, Cheshunt	Outside Nos. 75 - 78 Elderbek Close
vii 85 Elderbek Close, Cheshunt	Outside No. 87 Elderbek Close
viii 11 Lakeside Road, Cheshunt	Opposite No.15 Lakeside Road
ix 12 Mayo Close, Cheshunt	Opposite side of road
x 17 Shaw Close, Cheshunt	
xi 10 Cathrow Mews, Hoddesdon	
xii 59 Hertford Road, Hoddesdon	Side of No.53 Hertford Rd in Westfield Rd
xiii 103 Lampits, Hoddesdon	Side of No. 99 Lampits
xiv 45 Lilac Road, Hoddesdon	Side of No.45 in Laburnum Road
xv 139 Lord Street , Hoddesdon	
xvi 35 Middlefield Road, Hoddesdon	
xvii 76 Rye Road, Hoddesdon	
xviii 182 Rye Road, Hoddesdon	
xix 8 Saffron Close, Hoddesdon	
xx 20 The Knowle, Hoddesdon	
xxi 24 Walnut Tree Close, Hoddesdon	Side of Nos. 23 - 27 Walnut Tree Close
xxii 91 Berkley Avenue, Waltham Cross	
xxiii 84 Eleanor Road, Waltham Cross	
xxiv 29 Swanfield Road, Waltham Cross	

2. Remove the existing Disabled Persons' Parking Places at the following locations which are no longer being used;

- |   |                                   |
|---|-----------------------------------|
| 1. 111 Barrow Lane, Cheshunt                | 14. 36 Foxtan Road, Hoddesdon     |
| 2. 2 Burbage Close, Cheshunt                | 15. 18 Murchison Road, Hoddesdon  |
| 3. 20 Chadwell Avenue, Cheshunt             | 16. 26 North Road, Hoddesdon      |
| 4. 6 Clarendon Road, Cheshunt               | 17. 66 Old Essex Road, Hoddesdon  |
| 5. 33 Cliff Richard Court, High Rd Cheshunt | 18. 68 Rye Road, Hoddesdon        |
| 6. 20 Delamare Road, Cheshunt               | 19. 18 Winterscroft Rd, Hoddesdon |

- |                                   |                                |
|-----------------------------------|--------------------------------|
| 7. 53 Downfield Road, Cheshunt    | 20 33 Broomfield Ave, Turnford |
| 8. 15 Kingsley Avenue, Cheshunt   | 21 3 Cornwall Close, W. Cross  |
| 9. 123 Perrysfield Road, Cheshunt | 22 31 Queens Road, W. Cross    |
| 10. 93 Russells Ride, Cheshunt    | 23 67 Queens Road, W. Cross    |
| 11. 49 Smarts Green, Cheshunt     | 24 1 Macers lane, Wormley      |
| 12. 9 Wakefield Walk, Cheshunt    | 25 22 Wharf Road, Wormley      |
| 13 14 Cedar Green, Hoddesdon      |                                |

3. Relocate Disabled Persons Parking Place from outside No.28 Hammond Close, Cheshunt to a new position outside No. 29 Hammond Close 3.4 metres south of its current position.

The Order came in to force on 11th May 2017.

Documents giving more detailed particulars of the Order namely a copy of the Order and maps contained in it, showing each length of road to which the Order relates, a statement of the Council's reasons for making the Order, the Notice relating to the Council's intention to make the Order together with a copy of The Borough of Broxbourne (Control of Parking) Consolidation) Order 2013, The Borough of Broxbourne (Various Roads) (Disabled Persons' Parking Places) Order No. 2015, The Borough of Broxbourne (Various Roads) (Disabled Persons' Parking Places) Order No. 2016 may be inspected by visiting the Cheshunt One Stop Shop, Laura Trott Leisure Centre, Windmill Lane, CHESHUNT and the Hoddesdon One Stop Shop, Hoddesdon Library, 98A High Street, HODDESDON, between the hours of 9.00 am and 5.30 pm, Monday to Fridays and 9.00 am and 1.00 pm Saturdays, the Waltham Cross One Stop Shop, 123 High Street, WALTHAM CROSS between the hours of 9.00 am and 5.30 pm Monday to Fridays and 9.00 am and 4.00 pm Saturdays and at the office of the undersigned between the hours 8.30 am and 5.30 pm Monday to Fridays.

Any person wishing to question the validity of the Order or any of its provisions on the grounds that it or they are not within the powers conferred by the Road Traffic Regulation Act 1984, or on any grounds that any requirements of that Act or any regulations made thereunder has not been complied with, may within 6 weeks from 11<sup>th</sup> May 2017, make any application for this purpose to the High Court.

Dated 8th May 2017

Borough Offices  
Bishops' College  
Churchgate  
CHESHUNT  
Herts EN8 9XB



Peter Linkson  
Director of Environmental Services