



**BOROUGH OF
BROXBOURNE**
www.broxbourne.gov.uk

IMPORTANT - THIS COMMUNICATION AFFECTS YOUR PROPERTY

TOWN AND COUNTRY PLANNING ACT 1990
(as amended by the Planning and Compensation Act 1991)

ENFORCEMENT NOTICE
OPERATIONAL DEVELOPMENT

Issued by: Broxbourne Borough Council (“the Council”)

1. **THIS IS A FORMAL NOTICE** which is issued by the Council because it appears to it that there has been a breach of planning control, under Section 171A(1)(a) of the above Act, at the land described below. It considers that it is expedient to issue this notice, having regard to the provisions of the development plan and to other material planning considerations. The Annex at the end of the notice and the enclosures to which it refers contain important additional information.
2. **THE LAND TO WHICH THIS NOTICE RELATES**

Land lying north east side of Church Lane Wormley Broxbourne. Shown edged red on the attached plan.
3. **THE MATTERS WHICH APPEAR TO CONSTITUTE THE BREACH OF PLANNING CONTROL**

Without planning permission the unauthorised hard surfacing of land.

4. REASONS FOR ISSUING THIS NOTICE

- 4.1 It is considered that unauthorised development commenced within the last 4 years.
- 4.2 By reason of its location, the unauthorised hardstanding exerts significant harm to the land within this rural location, both in terms of harm to visual appearance and reduced openness. Furthermore, the development has resulted in the loss of natural vegetation within the site and has not demonstrated biodiversity net gain. It has also not been demonstrated that the development can be satisfactorily drained. The development is therefore contrary to GB1, DCS1, NEB1, NEB4, W1, W2 and W4 of the adopted Local Plan.

5. WHAT YOU ARE REQUIRED TO DO

- (i) To remove all deposited hard core materials laid to create the hard surfacing and return the site to its former condition.
- (ii) Permanently remove from the land all rubble, rubbish or debris arising from compliance with point (i) above.
- (iii) Restore the site to the condition that existed before the breach of planning control described above took place.
- (iv) Grade the land with topsoil and sow the bare earth with grass seed.

6. **TIME FOR COMPLIANCE**

Six months after this notice takes effect.

7. **WHEN THIS NOTICE TAKES EFFECT**

This Notice takes effect on **2nd June 2021** unless an appeal is made against it beforehand.

Dated: 4th May 2021

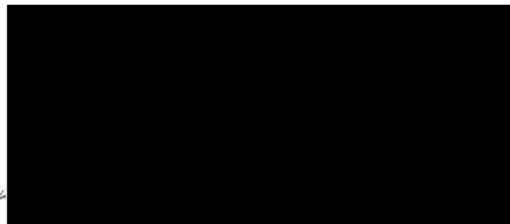
Signed: 

Douglas C Cooper
Head of Planning Department
Borough of Broxbourne
Bishops College, Churchgate
Cheshunt, EN8 9XE

WHO THIS ENFORCEMENT NOTICE IS SERVED ON:

- The Owner; Land lying north east side of Church Lane Wormley Broxbourne
- The Occupier(s); Land lying north east side of Church Lane Wormley Broxbourne
- John William Croke; 20a Church Lane Cheshunt Waltham Cross EN8 0DY

HM Land Registry Current title plan

Title number **HD579290**
Ordnance Survey map reference **TL3506SW**
Scale **1:2500**
Administrative area **Hertfordshire :**
Broxbourne

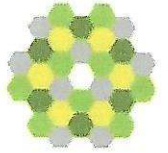

© Crown copyright and database rights. 2019 Ordnance Survey 100026316. You are not permitted to copy, sub-license, distribute or sell any of this data to third parties in any form.

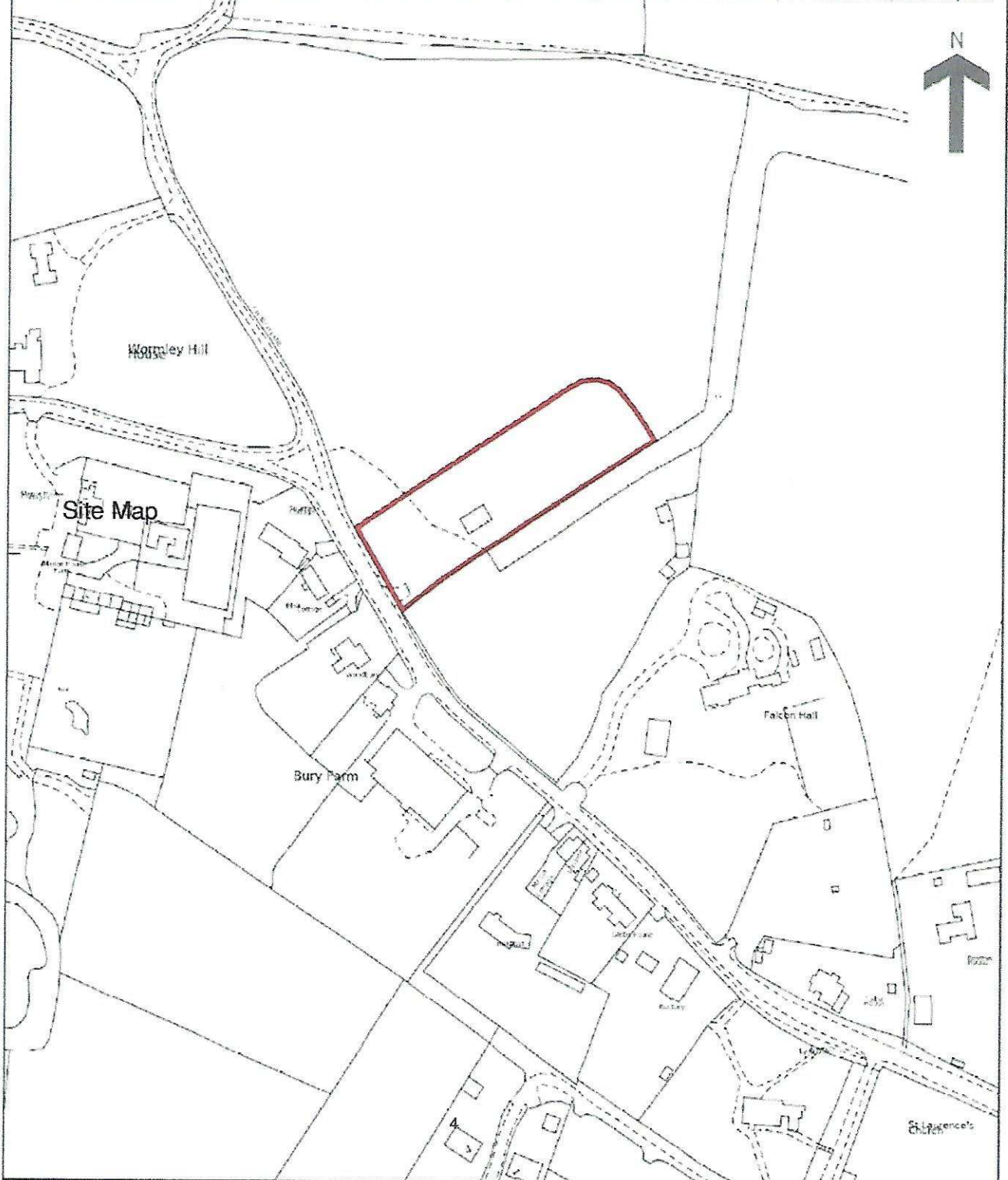

YOUR RIGHT OF APPEAL

You can appeal against this notice, provided the appeal is received or posted in time to be received by The Planning Inspectorate before the effective date.

The enclosed information explains how you may request the necessary forms to enable you to appeal:

- The Planning Inspectorate;
Wherever possible you should make your appeal(s) on-line through the Planning Portal: <http://www.planningportal.gov.uk/planning/appeals/online/makeanappea>

Or by post to: Customer Support Team, Room 3/13, Temple Quay House, 2 The Square, Bristol, BS1 6PN

Or by email to: enquiries@planning-inspectorate.gsi.gov.uk
Contact telephone: 0303 444 5000

- Development Management, Broxbourne Borough Council
Bishops' College | Churchgate | Cheshunt | EN8 9XQ - Contact telephone: 01992 785555 – Email - planning@broxbourne.gov.uk

The Planning Inspectorate has introduced an online appeals service which you can use to make your appeal online. You can find the service through the Appeals area of the Planning Portal at www.planningportal.gov.uk/pcs. The Inspectorate will publish details of your appeal on the Internet (on the Appeals area of the Planning Portal). This may include a copy of the original planning application form and relevant supporting documents supplied to the local authority by you or your agent, together with the completed appeal form and information you submit to the Planning Inspectorate. Please ensure that you only provide information, including personal information belonging to you that you are happy will be made available to others in this way. If you supply personal information belonging to a third party please ensure you have their permission to do so. More detailed information about data protection and privacy matters is available on the Planning Portal.

Please note that a separate appeal form must be completed for each individual person or individual organisation. Each appeal may attract a fee as set out below.

IF YOU APPEAL

If you lodge an appeal then you must submit to The Planning Inspectorate a statement in writing specifying the grounds on which you are appealing against the enforcement notice, and stating briefly the facts that you propose to rely on, in support of each of these grounds, either

- When giving notice of appeal OR
- Within 14 days from the date that The Planning Inspectorate sends you a notice that requires you to send a statement

If you wish to have your appeal also considered as an express application for planning permission, or you intend to make an appeal under Ground (a), you may be required to pay a fee.

A fee may be payable for the express application for planning permission for the development alleged to be in breach of planning control in the enforcement notice. This is pursuant to regulation 10 of the Town and Country Planning (Fees for Applications and Deemed Applications) Regulations 1989 (7).

The fee for this case is **£924.00**. This amount is payable to the Council.

- Once your appeal has been submitted to the Planning Inspectorate, payment can be made by phone with the Planning Technical Support Team on 01992 785555 or planning@broxbourne.gov.uk. Please quote the Enforcement Case Reference Number (see the top of this Notice) and the Appeal Reference Number (see the top of your electronically completed appeal form).
- The Development Management Service no longer take payment by cheque. Payment may be made by Credit Card or by BACS.

WHAT HAPPENS IF YOU DO NOT APPEAL

If you do not appeal against this enforcement notice before the effective date you may be held responsible. Therefore you must ensure that the required steps detailed under the heading "What you are required to do", of Schedule 4 of this notice are complied with, within the period specified in the notice.

Failure to comply with an enforcement notice, that has taken effect, can result in prosecution and/or direct action by the Council.



The Planning Inspectorate

CST Room 3/05
Temple Quay House
2 The Square
Temple Quay
Bristol BS1 6PN

Direct Line 0117-372 6372

Switchboard 0117-372 8000
Fax No 0117-372 8782

www.planning-inspectorate.gov.uk

THIS IS IMPORTANT

If you want to appeal against this enforcement notice you can do it in writing:-

- on-line at the Planning Casework Service area of the Planning Portal (www.planningportal.gov.uk/pcs); or
- by getting enforcement appeal forms by phoning us on 0117 372 6372 or by emailing us enquiries@pins.gsi.gov.uk

You MUST make sure that we receive your appeal before the effective date on the enforcement notice.

In exceptional circumstances you may give notice of appeal by fax or letter. You should include:-

- the name of the local planning authority;
- the site address;
- your address; and
- the effective date of the enforcement notice.

We MUST receive this before the effective date on the enforcement notice. This should **immediately** be followed by your completed appeal forms.

A copy of the booklet 'Guide to taking part in enforcement appeals' is available free of charge from the Planning Portal website. The booklet provides information on the various grounds of appeal.

Guide to taking part in enforcement appeals proceeding by written representations
http://www.planningportal.gov.uk/uploads/pins/taking-part_enforcement-written.pdf

Guide to taking part in enforcement appeals proceeding by a hearing
http://www.planningportal.gov.uk/uploads/pins/taking-part_enforcement-hearing.pdf

Guide to taking part in enforcement appeals proceeding by an inquiry
http://www.planningportal.gov.uk/uploads/pins/taking-part_enforcement-inquiry.pdf

Further information regarding appeals can be found using the following link
<http://www.planningportal.gov.uk/planning/appeals/online/makeanappeal>

Copies of the 'How to complete your enforcement appeal form' booklet is available via