

TOWN & COUNTRY PLANNING ACTS, 1971 and 1972

Other Ref. No.

THE DISTRICT COUNCIL OF THE COUNTY OF HERTFORD

To C G Edward (Goffs Oak) Ltd 104 Cuffley Hill Goffs Oak Cheshunt Herts

Continuation of use of gravel pit for the extraction of sand and gravel and continuation of filling and restoration at Existing sand/gravel pit, Church Lane, Wormley, Herts

Brief description and location of proposed development.

In pursuance of their powers under the above-mentioned Acts and the Orders and Regulations for the time being in force thereunder, the Council hereby refuse the development proposed by you in your application dated Twenty fourth of May 1979 and received with sufficient particulars on First of June 1979 and shown on the plan(s) accompanying such application.

The reasons for the Council's decision to refuse permission for the development are:- numbered 1-4 on attached sheet

Dated Eleventh day of October 1979

Signed

Designation

Principal Assistant County Secretary

SEE NOTES OVERLEAF

Town Planning  
Ref. No. 1150-18  
Date  
Ref. No.

THE DISTRICT COUNCIL OF  
THE COUNTY OF HERTFORD

NOTE

- (1) If the applicant wishes to have an explanation of the reasons for this decision it will be given on request and a meeting arranged if necessary.
- (2) If the applicant is aggrieved by the decision of the local planning authority to refuse permission or approval for the proposed development, or to grant permission or approval subject to conditions, he may appeal to the Secretary of State for the Environment, in accordance with section 36 of the Town and Country Planning Act 1971, within six months of receipt of this notice. (Appeals must be made on a form which is obtainable from the Secretary of State for the Environment, Whitehall, London, S.W.1.) The Secretary of State has power to allow a longer period for the giving of a notice of appeal but he will not normally be prepared to exercise this power unless there are special circumstances which excuse the delay in giving notice of appeal. The Secretary of State is not required to entertain an appeal if it appears to him that permission for the proposed development could not have been granted by the local planning authority, or could not have been so granted otherwise than subject to the conditions imposed by them, having regard to the statutory requirements, to the provisions of the development order, and to any directions given under the order.
- (3) If permission to develop land is refused, or granted subject to conditions, whether by the local planning authority or by the Secretary of State for the Environment and the owner of the land claims that the land has become incapable of reasonably beneficial use in its existing state and cannot be rendered capable of reasonably beneficial use by the carrying out of any development which has been or would be permitted, he may serve on the District Council in which the land is situated, a purchase notice requiring that council to purchase his interest in the land in accordance with the provisions of Part IX of the Town and Country Planning Act 1971.
- (4) In certain circumstances, a claim may be made against the local planning authority for compensation, where permission is refused or granted subject to conditions by the Secretary of State on appeal or on a reference of the application to him. The circumstances in which such compensation is payable are set out in section 169 of the Town and Country Planning Act 1971.

1979  
*[Signature]*

Date of Event

Principal Assistant County Secretary  
SEE NOTES OVERLEAF

1. It is considered by the Local Planning Authority that there has been adequate time within which all the sand and gravel deposits at the site could have been worked out and the pit restored satisfactorily as required by Condition Number 5 of the planning permission E/280-48, dated 30 June 1949.

Any permission granted to extract materials would delay further the restoration of the site to a state capable of supporting plant life and its initial cultivation, as required by that condition.

2. The proposed sand and gravel extraction would be likely to prove detrimental to the amenities enjoyed by local residents, and in particular those occupying dwellings in the vicinity of the site, by reason of noise, general disturbance and loss of visual amenity arising from the activities at the site, throughout the period during which gravel working would be in progress.
3. The proposal is likely to generate a traffic loading on C 56 and other local roads which would materially shorten the life of the road structures.
4. The site is within the Metropolitan Green Belt, and in the Area of Great Landscape Value as defined in the approved County Development Plan and is similarly defined in the non-statutory planning objectives and policies document 'Hertfordshire 1981' where it is the policy of the Local Planning Authority not to permit development unless it is essential for agriculture or other genuine Green Belt purposes, or unless there is some quite outstanding reason why permission should be granted. No such need or special circumstances are apparent in this case.



1. The first part of the document is a list of names and addresses of the members of the committee. The names are listed in alphabetical order, and the addresses are given in full. The list is as follows:

Mr. J. H. ...  
Mr. ...  
Mr. ...

2. The second part of the document is a report on the work of the committee during the year. It begins with a statement of the committee's purpose and then goes on to describe the various projects and activities that were carried out. The report is written in a clear and concise style, and it provides a detailed account of the committee's work.

3. The third part of the document is a list of the committee's recommendations for the future. These recommendations are based on the findings of the report and are intended to guide the work of the committee in the coming year.

4. The fourth part of the document is a list of the names and addresses of the members of the committee for the following year. This list is identical to the one in the first part of the document, but it is placed at the end of the report to indicate the continuity of the committee's work.

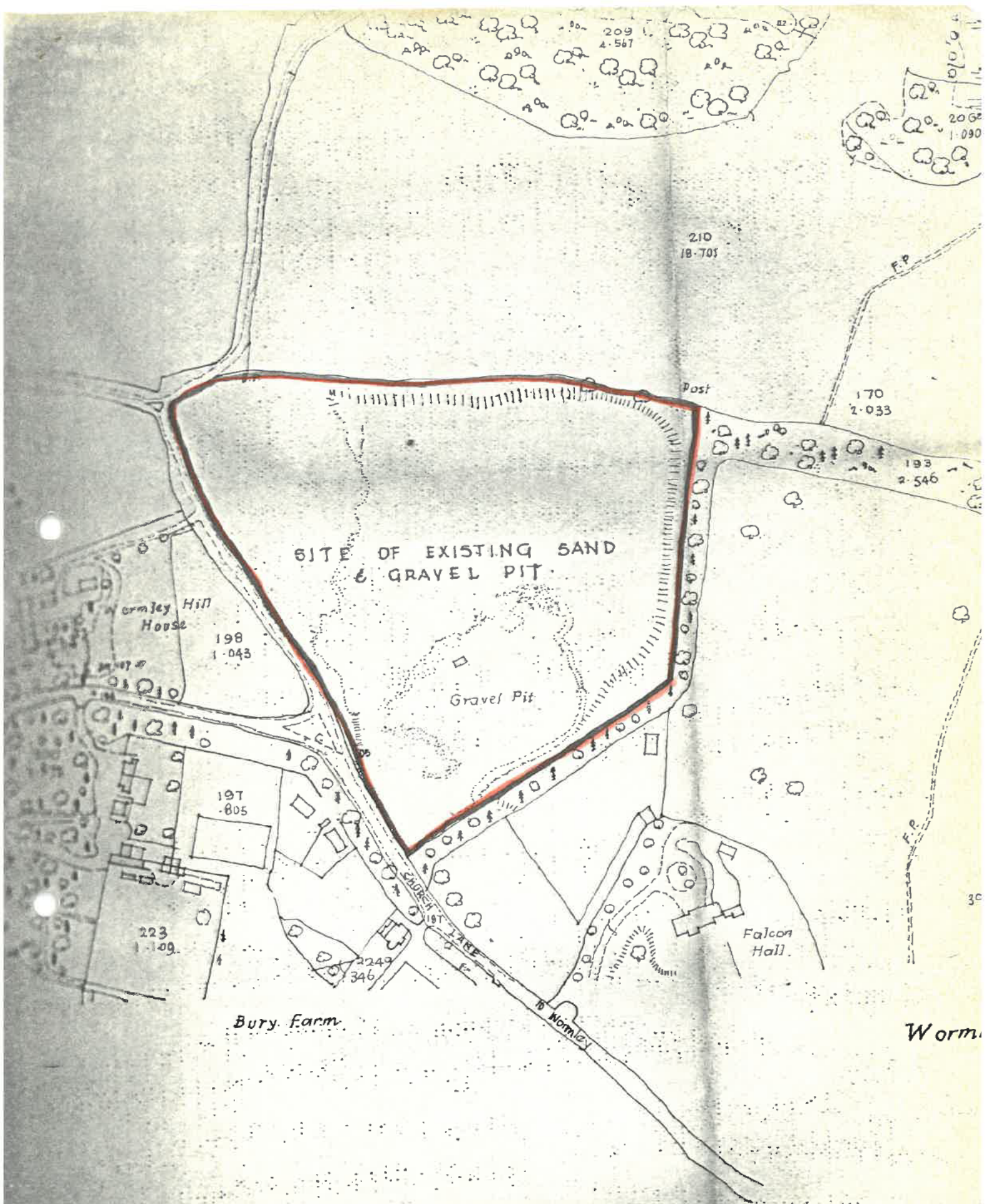

SITE OF EXISTING SAND & GRAVEL PIT

Gravel Pit

Wormley Hill House

Falcon Hall

Bury Farm

Worm.

210  
18-705

170  
2-033

198  
1-043

197  
805

223  
1-109

2249  
346

209  
4-567

206  
1-090

193  
2-546

SAUNDERS LANE

B. Wormley

Post

F.P.

F.P.

7/520-7A

